

13

**TENTH AMENDMENT TO MASTER DEED OF  
OAKRIDGE VILLAGE - MAPLEWOOD RESERVE**

**ADDITION OF PHASE 10  
(BUILDING 17)**

VRD ACQUISITION, LLC, a Massachusetts limited liability company with a place of business at 100 Andover By-Pass, North Andover, Massachusetts 01845 being the successor Declarant by deed dated September 1, 2009 and recorded at Book 11757, Page 4 under a Master Deed dated March 14, 2006 and recorded with Essex North District Registry of Deeds (the "Registry") at Book 10082, Page 1, as amended by First Amendment to Master Deed dated April 13, 2006 and recorded with the Registry at Book 10128, Page 127 (the "First Amendment"), Second Amendment to Master Deed dated April 19, 2006 and recorded with the Registry at Book 10140, Page 147, Third Amendment to Master Deed dated June 30, 2006 and recorded with the Registry at Book 10285, Page 169, Fourth Amendment to Master Deed dated August 16, 2006 and recorded with the Registry at Book 10356, Page 32, Fifth Amendment to Master Deed dated October 10, 2006 and recorded with the Registry at Book 10443, Page 137 and Sixth Amendment to Master Deed dated October 23, 2006 and recorded with the Registry at Book 10468, Page 39 and Seventh Amendment to Master Deed dated March 14, 2007 and recorded with the Registry in Book 10667, Page 281 and Eight Amendment to Master Deed dated October 19, 2007 and recorded with the Registry at Book 10947, Page 268 and Ninth Amendment to Master Deed dated July 9, 2010 and recorded with the Registry at Book 12103, Page 214 (the "Master Deed"), pursuant to the rights reserved in paragraphs 14 and 18 of the Master Deed to amend the Master Deed, including the right to add additional phases, does hereby amend the Master Deed as contained herein, including the addition of Phase Ten (Building 17) to the Condominium. Capitalized terms used but not defined in this Amendment shall have the same definitions given to them in the Master Deed.

1. Phase 10 consists of Building 17 containing three (3) townhouse Units;
2. The Master Deed is hereby amended as follows:
  - (a) Paragraph 5 of the Master Deed is hereby amended by deleting the existing Condominium Site Plan(s) and substituting it with a certain plans entitled "Condominium Site Plan - Phase X, Oakridge Village / Maplewood Reserve, North Andover, Mass. Drawn for Valley Realty Development, LLC", dated: October 27, 2010, by Merrimack Engineering Services and recorded with the Registry as Plan Nos. 16353 & 16354
  - (b) The Units for Phase 10 (Building 17) are shown on the plans entitled "Project: Maplewood Reserve Building 17 1701-1703 Dogwood Circle, North Andover, Mass." dated, October 11, 2010, containing Sheets 1 through 3, prepared by Vorbach Architecture in accordance with Section 8(f) of the Act and recorded with the Registry as Plan Nos. 16363-16364 and the Floor Plans described in Paragraph 6(a) of the Master Deed, are hereby amended to include the above-described plans.
  - (c) Exhibit B to the Master Deed is hereby amended by deleting the existing Exhibit B and substituting it with the Exhibit B attached hereto and made a part hereof.

- (d) Exhibit C to the Master Deed is hereby amended by deleting the existing Exhibit C and substituting it with the Exhibit C attached hereto and made a part hereof.
3. Giving effect to the foregoing, Phase 10 (Building 17) is hereby added to the Condominium.
  4. Unit 1604 is an "Affordable Unit" designated as "Affordable" pursuant to the Regulatory Agreement. Unit 1605 was inadvertently listed as an "Affordable" unit under the Ninth Phasing Amendment. Any discrepancy between the percentage interests of these Units as listed in prior phasing amendments is hereby corrected so that the percentage interest of Unit 1604 is lower in this Tenth Amendment due to its affordable status and the percentage interest of Unit 1605 is higher due to the unit not being affordable status.
  5. Phase 9 of the Condominium consisted of Building 16 which contains six (6) townhouse units and five (5) garage spaces. The garage spaces were inadvertently left off the Ninth phasing amendment adding Building 16 to the Condominium.
  6. Except as hereby amended, the Master Deed is ratified and confirmed in all respects.

IN WITNESS WHEREOF, the said VRD Acquisition, LLC has caused these presents to be executed this 12<sup>th</sup> day of November, 2010.

VRD Acquisition, LLC

By: 

Name: Anthony Mesiti  
Manager

**EXHIBIT B****DESCRIPTION OF BUILDINGS**

There are seventeen (17) Buildings on the Land described in Exhibit A to this Master Deed contained in phases 1, 2, 3, 4, 5, 6, 7, 8, 9 and 10 of the Condominium. Said Buildings are described as follows:

1. A one (1) story community building containing an indoor swimming pool, shown on the Condominium Site Plan as "1 Story Community Building #5, #5 Harvest Drive".
2. A three (3) story building consisting of thirty eight (38) residential Units shown on the Condominium Site Plan as "3 Story 38 Unit Building #2, #2 Harvest Drive." Said building contains Unit 101 through 312.
3. A two and one-half (2 1/2) story building consisting of twelve (12) residential Townhouse Units and one (1) Garage shown on the Condominium Site Plan as "2 1/2 Story 12 Unit Building #6 601-612 Alder Way." Said building contains Units 601-612.
4. A one (1) story building consisting of five (5) Garages shown on the Condominium Site Plan as "1 Story 5 Car Garage Building #7".
5. A one (1) story building consisting of six (6) Garages shown on the Condominium Site Plan as "1 Story 6 Car Garage Building #8".
6. A three (3) story building consisting of thirty eight (38) residential Units and forty (40) Indoor Parking Spaces, shown on the Condominium Site Plan as "3 Story 38 Unit Building #3, #3 Harvest Drive". Said building contains Units 101 through 312.
7. A two and one-half (2 1/2) story building consisting of six (6) residential Townhouse Units and one (1) Garage shown on the Condominium Site Plan as "2 1/2 Story 6 Unit Building #9 901-906 Alder Way". Said building contains Unit 901 through 906.
8. A one (1) story building consisting of nine (9) Garages shown on the Condominium site Plan as "1 Story 9 Car Garage Building #10".
9. A two and one-half (2 1/2) story building consisting of six (6) residential Townhouse Units shown on the Condominium Site Plan as "2 1/2 Story 6 Unit Building #11 1101-1106 Acorn Drive". Said building contains Unit 1101 through 1106.
10. A one (1) story building consisting of six (6) Garages shown on the Condominium Site Plan as "1 Story 6 Car Garage Building #12".
11. A two and one-half (2 1/2) story building consisting of six (6) residential Townhouse Units and three (3) Garages shown on the Condominium Site Plan as "2 1/2 Story 6 Unit Building #13 1301-1306 Basswood Circle". Said building contains Unit 1301 through 1306.
12. A two and one-half (2 1/2) story building consisting of five (5) residential Townhouse Units and four (4) Garages shown on the Condominium Site Plan as "2 1/2 Story 6 Unit Building #14 1401-1405 Basswood Circle". Said building contains Units 1401 through 1405.
13. A two and one-half (2 1/2) story building consisting of three (3) residential Townhouse Units and three (3) Garages shown on the Condominium Site Plan as "2 1/2 Story 6 Unit Building #15 1501-1503 Basswood Circle". Said building contains Units 1501 through 1503.
14. A three (3) story building consisting of two sections (4N and 4E) containing a total of seventy seven (77) residential Units and eighty four (84) Indoor Parking Spaces. 4N is shown on the Condominium Site Plan as "3 Story 36 Unit Building #4N, #4 Harvest Drive" and 4E is shown on the Condominium Site Plan as "3 Story 36 Unit Building

#4E, #4 Harvest Drive". Said Building 4E contains Units 101 through 112, 201 through 212, and Units 301 through 312 and building 4N contains Units 113 through 125, 213 through 226 and 313 through 326.

15. A three (3) story building consisting of thirty (38) residential Units, shown on the Condominium Site Plan as "3 Story 38 Unit Building #1, #1 Harvest Drive". Said building contains Units 101 through 312.
16. A two and one-half (2 ½) story building consisting of six (6) residential Units and five (5) Garages shown on the Condominium Site Plan as "2 ½ Story Building #16".
17. A two and one-half (2 ½) story building consisting of three (3) residential Units shown on the Condominium Site Plan as "2 ½ Story Building #17".

EXHIBIT C  
DESCRIPTION OF UNITS

| Bldg # <sup>1</sup> | Unit # | # of Rooms <sup>2</sup> | Approx. Sq. Ft. <sup>3</sup> | Location/<br>Floor(s) | Proportionate Interst (%) for Units |
|---------------------|--------|-------------------------|------------------------------|-----------------------|-------------------------------------|
| 2                   | 101    | 4                       | 1154                         | First                 | 0.427973%                           |
| 2                   | 102    | 4                       | 1159                         | First                 | 0.427973%                           |
| 2                   | 103    | 3                       | 860                          | First                 | 0.334354%                           |
| 2                   | 104    | 3                       | 852                          | First                 | 0.333017%                           |
| 2                   | 105    | 3                       | 856                          | First                 | 0.333017%                           |
| 2                   | 106    | 4                       | 1077                         | First                 | 0.427973%                           |
| 2                   | 107    | 3                       | 852                          | First                 | 0.334354%                           |
| 2                   | 108    | 4                       | 1077                         | First                 | 0.427973%                           |
| 2                   | 109    | 3                       | 855                          | First                 | 0.333017%                           |
| 2                   | 110    | 3                       | 852                          | First                 | 0.333017%                           |
| 2                   | 111    | 3                       | 859                          | First                 | 0.334354%                           |
| 2                   | 112    | 4                       | 1159                         | First                 | 0.427973%                           |
| 2                   | 113    | 4                       | 1152                         | First                 | 0.427973%                           |
| 2                   | 201    | 4                       | 1116                         | Second                | 0.427973%                           |
| 2                   | 202    | 4                       | 1117                         | Second                | 0.427973%                           |
| 2                   | 203    | 4                       | 1039                         | Second                | 0.363777%                           |
| 2                   | 204    | 4                       | 1259                         | Second                | 0.427973%                           |
| 2                   | 205    | 3                       | 814                          | Second                | 0.334354%                           |
| 2                   | 206    | 4                       | 1035                         | Second                | 0.363777%                           |

<sup>1</sup> As shown on the Condominium Site Plan. The post office address for : (i) Building 1 is 1 Harvest Drive, North Andover, MA 01845; (ii) Building 2 is 2 Harvest Drive, North Andover, MA 01845; (iii) Building 6 is 601-612 Alder Way, North Andover, MA 01845; (iv) Building 3 is 3 Harvest Drive, North Andover, MA 01845; (v) Building 9 is 901-906 Alder Way, North Andover, MA 01845; (vi) Building 11 is 1101-1106 Acorn Drive, North Andover, MA 01845; (vii) Building 13 is 1301-1306 Basswood Circle, North Andover, MA 01845; (viii) Building 14 is 1401-1405 Basswood Circle, North Andover, MA 01845; (ix) Building 15 is 1501-1503 Basswood Circle, North Andover, MA 01845; (x) Building 4N and 4E are 4 Harvest Drive, North Andover, MA 01845; (xi) Building 1 is 1 Harvest Drive, North Andover, MA 01845; (xii) Building 16 is 1601-1606 Catalpa Drive, North Andover, MA 01845 (xiii) Building 17 is 1701-1703 Dogwood Circle, North Andover, MA 01845

<sup>2</sup> Closets, Mechanical Closets, Mechanical rooms, Bathrooms, Balconies and Decks are not included in the number of rooms in the column headed # of Rooms.

<sup>3</sup> The approximate area of the Unit in square feet set forth does not include any balcony or deck.

| Bldg # | Unit # | # of Rooms | Approx. Sq. Ft. | Location/ Floor(s)                                | Proportionate Interest (%) for Units |
|--------|--------|------------|-----------------|---|--------------------------------------|
| 2      | 207    | 3          | 857             | Second  | 0.333017%                            |
| 2      | 208    | 4          | 1036            | Second  | 0.427973%                            |
| 2      | 209    | 3          | 813             | Second  | 0.334354%                            |
| 2      | 210    | 4          | 1261            | Second  | 0.427973%                            |
| 2      | 211    | 4          | 1032            | Second  | 0.363777%                            |
| 2      | 212    | 4          | 1117            | Second  | 0.427973%                            |
| 2      | 213    | 4          | 1118            | Second  | 0.427973%                            |
| 2      | 301    | 4          | 1121            | Third   | 0.427973%                            |
| 2      | 302    | 4          | 1118            | Third   | 0.427973%                            |
| 2      | 303    | 4          | 1043            | Third   | 0.363777%                            |
| 2      | 304    | 4          | 1267            | Third   | 0.427973%                            |
| 2      | 305    | 4          | 1257            | Third   | 0.427973%                            |
| 2      | 306    | 4          | 1031            | Third   | 0.363777%                            |
| 2      | 307    | 4          | 1257            | Third   | 0.427973%                            |
| 2      | 308    | 4          | 1038            | Third   | 0.427973%                            |
| 2      | 309    | 4          | 1035            | Third   | 0.427973                             |
| 2      | 310    | 4          | 1264            | Third   | 0.427973%                            |
| 2      | 311    | 4          | 1117            | Third   | 0.363777%                            |
| 2      | 312    | 4          | 1121            | Third   | 0.427973%                            |
| 6      | 601    | 6          | 1912            | 1 <sup>st</sup> ,2 <sup>nd</sup> ,3 <sup>rd</sup> | 0.561715%                            |
| 6      | 602    | 5          | 1911            | 1 <sup>st</sup> ,2 <sup>nd</sup> ,3 <sup>rd</sup> | 0.561715%                            |
| 6      | 603    | 5          | 1904            | 1 <sup>st</sup> ,2 <sup>nd</sup> ,3 <sup>rd</sup> | 0.561715%                            |
| 6      | 604    | 6          | 1919            | 1 <sup>st</sup> ,2 <sup>nd</sup> ,3 <sup>rd</sup> | 0.561715%                            |
| 6      | 605    | 6          | 2044            | 1 <sup>st</sup> ,2 <sup>nd</sup> ,3 <sup>rd</sup> | 0.561715%                            |
| 6      | 606    | 6          | 1916            | 1 <sup>st</sup> ,2 <sup>nd</sup> ,3 <sup>rd</sup> | 0.561715%                            |
| 6      | 607    | 5          | 1909            | 1 <sup>st</sup> ,2 <sup>nd</sup> ,3 <sup>rd</sup> | 0.561715%                            |
| 6      | 608    | 5          | 1911            | 1 <sup>st</sup> ,2 <sup>nd</sup> ,3 <sup>rd</sup> | 0.397213%                            |
| 6      | 609    | 5          | 1905            | 1 <sup>st</sup> ,2 <sup>nd</sup> ,3 <sup>rd</sup> | 0.561715%                            |
| 6      | 610    | 5          | 1911            | 1 <sup>st</sup> ,2 <sup>nd</sup> ,3 <sup>rd</sup> | 0.397213%                            |
| 6      | 611    | 6          | 1908            | 1 <sup>st</sup> ,2 <sup>nd</sup> ,3 <sup>rd</sup> | 0.561715 %                           |

| Bldg # | Unit # | # of Rooms | Approx. Sq. Ft. | Location/ Floor(s)                | Proportionate Interest (%) for Units |
|--------|--------|------------|-----------------|-----------------------------------|--------------------------------------|
| 6      | 612    | 7          | 1905            | 1 <sup>st</sup> , 2 <sup>nd</sup> | 0.5617159%                           |
| 3      | 101    | 4          | 1149            | First                             | 0.427973%                            |
| 3      | 102    | 4          | 1155            | First                             | 0.427973%                            |
| 3      | 103    | 4          | 1054            | First                             | 0.427973%                            |
| 3      | 104    | 3          | 859             | First                             | 0.333017%                            |
| 3      | 105    | 3          | 850             | First                             | 0.333017                             |
| 3      | 106    | 4          | 1080            | First                             | 0.427973%                            |
| 3      | 107    | 3          | 847             | First                             | 0.334354%                            |
| 3      | 108    | 4          | 1079            | First                             | 0.427973%                            |
| 3      | 109    | 3          | 854             | First                             | 0.333017%                            |
| 3      | 110    | 3          | 858             | First                             | 0.333017%                            |
| 3      | 111    | 4          | 1051            | First                             | 0.427973%                            |
| 3      | 112    | 4          | 1150            | First                             | 0.427973%                            |
| 3      | 113    | 4          | 1152            | First                             | 0.427973%                            |
| 3      | 201    | 4          | 1116            | Second                            | 0.427973%                            |
| 3      | 202    | 4          | 1114            | Second                            | 0.427973%                            |
| 3      | 203    | 4          | 1029            | Second                            | 0.363777%                            |
| 3      | 204    | 4          | 1264            | Second                            | 0.427973%                            |
| 3      | 205    | 3          | 809             | Second                            | 0.334354%                            |
| 3      | 206    | 4          | 1034            | Second                            | 0.3663777%                           |
| 3      | 207    | 3          | 848             | Second                            | 0.333017%                            |
| 3      | 208    | 4          | 1035            | Second                            | 0.427973%                            |
| 3      | 209    | 3          | 806             | Second                            | 0.334354%                            |
| 3      | 210    | 4          | 1264            | Second                            | 0.427973%                            |
| 3      | 211    | 4          | 1026            | Second                            | 0.363777%                            |
| 3      | 212    | 4          | 1115            | Second                            | 0.427973%                            |

| Bldg # | Unit # | # of Rooms | Approx. Sq. Ft. | Location/ Floor(s)                                  | Proportionate Interest (%) for Units |
|--------|--------|------------|-----------------|---|--------------------------------------|
| 3      | 213    | 4          | 1111            | Second  | 0.427973%                            |
| 3      | 301    | 4          | 1112            | Third   | 0.427973%                            |
| 3      | 302    | 4          | 1114            | Third   | 0.427973%                            |
| 3      | 303    | 4          | 1030            | Third   | 0.363777%                            |
| 3      | 304    | 4          | 1267            | Third   | 0.427973%                            |
| 3      | 305    | 4          | 1243            | Third   | 0.427973%                            |
| 3      | 306    | 4          | 1058            | Third   | 0.363777%                            |
| 3      | 307    | 4          | 1243            | Third   | 0.427973%                            |
| 3      | 308    | 4          | 1042            | Third   | 0.427973%                            |
| 3      | 309    | 4          | 1028            | Third   | 0.427973%                            |
| 3      | 310    | 4          | 1270            | Third   | 0.427973%                            |
| 3      | 311    | 4          | 1107            | Third   | 0.427973%                            |
| 3      | 312    | 4          | 1120            | Third   | 0.427973%                            |
| 9      | 901    | 6          | 1896            | 1 <sup>st</sup> , 2 <sup>nd</sup> , 3 <sup>rd</sup> | 0.561715%                            |
| 9      | 902    | 5          | 1918            | 1 <sup>st</sup> , 2 <sup>nd</sup> , 3 <sup>rd</sup> | 0.397213%                            |
| 9      | 903    | 6          | 1912            | 1 <sup>st</sup> , 2 <sup>nd</sup> , 3 <sup>rd</sup> | 0.561715%                            |
| 9      | 904    | 6          | 1912            | 1 <sup>st</sup> , 2 <sup>nd</sup> , 3 <sup>rd</sup> | 0.561715%                            |
| 9      | 905    | 5          | 1916            | 1 <sup>st</sup> , 2 <sup>nd</sup> , 3 <sup>rd</sup> | 0.397213%                            |
| 9      | 906    | 7          | 1905            | 1 <sup>st</sup> , 2 <sup>nd</sup> , 3 <sup>rd</sup> | 0.561715%                            |
| 11     | 1101   | 6          | 1636            | 1 <sup>st</sup> , 2 <sup>nd</sup>                   | 0.561715%                            |
| 11     | 1102   | 5          | 1917            | 1 <sup>st</sup> , 2 <sup>nd</sup> , 3 <sup>rd</sup> | 0.561715%                            |
| 11     | 1103   | 6          | 2106            | 1 <sup>st</sup> , 2 <sup>nd</sup> , 3 <sup>rd</sup> | 0.397213%                            |
| 11     | 1104   | 5          | 1715            | 1 <sup>st</sup> , 2 <sup>nd</sup> , 3 <sup>rd</sup> | 0.561715%                            |
| 11     | 1105   | 5          | 1911            | 1 <sup>st</sup> , 2 <sup>nd</sup> , 3 <sup>rd</sup> | 0.561715%                            |
| 11     | 1106   | 6          | 1646            | 1 <sup>st</sup> , 2 <sup>nd</sup>                   | 0.561715%                            |
| 13     | 1301   | 6          | 1909            | 1 <sup>st</sup> , 2 <sup>nd</sup> , 3 <sup>rd</sup> | 0.561715%                            |

| Bldg # | Unit # | # of Rooms | Approx. Sq. Ft. | Location/ Floor(s)                                  | Proportionate Interest (%) for Units |
|--------|--------|------------|-----------------|---|--------------------------------------|
| 13     | 1302   | 5          | 1915            | 1 <sup>st</sup> , 2 <sup>nd</sup> , 3 <sup>rd</sup> | 0.397213%                            |
| 13     | 1303   | 5          | 1917            | 1 <sup>st</sup> , 2 <sup>nd</sup> , 3 <sup>rd</sup> | 0.561715%                            |
| 13     | 1304   | 5          | 1720            | 1 <sup>st</sup> , 2 <sup>nd</sup> , 3 <sup>rd</sup> | 0.397213%                            |
| 13     | 1305   | 6          | 2110            | 1 <sup>st</sup> , 2 <sup>nd</sup> , 3 <sup>rd</sup> | 0.397213%                            |
| 13     | 1306   | 7          | 1936            | 1 <sup>st</sup> , 2 <sup>nd</sup>                   | 0.561715%                            |
| 14     | 1401   | 6          | 2099            | 1 <sup>st</sup> , 2 <sup>nd</sup> , 3 <sup>rd</sup> | 0.397213%                            |
| 14     | 1402   | 5          | 1712            | 1 <sup>st</sup> , 2 <sup>nd</sup> , 3 <sup>rd</sup> | 0.397213%                            |
| 14     | 1403   | 5          | 1907            | 1 <sup>st</sup> , 2 <sup>nd</sup> , 3 <sup>rd</sup> | 0.561715%                            |
| 14     | 1404   | 5          | 1910            | 1 <sup>st</sup> , 2 <sup>nd</sup> , 3 <sup>rd</sup> | 0.397213%                            |
| 14     | 1405   | 6          | 1897            | 1 <sup>st</sup> , 2 <sup>nd</sup> , 3 <sup>rd</sup> | 0.397213%                            |
| 15     | 1501   | 6          | 1896            | 1 <sup>st</sup> , 2 <sup>nd</sup> , 3 <sup>rd</sup> | 0.561715%                            |
| 15     | 1502   | 5          | 1909            | 1 <sup>st</sup> , 2 <sup>nd</sup> , 3 <sup>rd</sup> | 0.397213%                            |
| 15     | 1503   | 5          | 1566            | 1 <sup>st</sup> , 2 <sup>nd</sup>                   | 0.561715%                            |
| 4E     | 101    | 4          | 1146            | First   | 0.427973%                            |
| 4E     | 102    | 4          | 1151            | First   | 0.427973%                            |
| 4E     | 103    | 4          | 1058            | First   | 0.363777%                            |
| 4E     | 104    | 4          | 1295            | First   | 0.427973%                            |
| 4E     | 105    | 4          | 1073            | First   | 0.427973%                            |
| 4E     | 106    | 4          | 1297            | First   | 0.363777%                            |
| 4E     | 107    | 4          | 1074            | First   | 0.427973%                            |
| 4E     | 108    | 3          | 856             | First   | 0.333017%                            |
| 4E     | 109    | 4          | 1296            | First   | 0.427973%                            |
| 4E     | 110    | 4          | 1293            | First   | 0.427973%                            |
| 4E     | 111    | 4          | 1292            | First   | 0.427973%                            |
| 4E     | 112    | 3          | 816             | First   | 0.333017                             |
| 4N     | 113    | 4          | 1340            | First   | 0.427973%                            |
| 4N     | 114    | 4          | 1215            | First   | 0.427973%                            |
| 4N     | 115    | 4          | 1297            | First   | 0.363777%                            |
| 4N     | 116    | 4          | 1268            | First   | 0.363777%                            |
| 4N     | 117    | 4          | 1268            | First   | 0.427973%                            |
| 4N     | 118    | 3          | 860             | First   | 0.334354%                            |
| 4N     | 119    | 4          | 1080            | First   | 0.363777%                            |

| Bldg # | Unit # | # of Rooms | Approx. Sq. Ft. | Location/ Floor(s) | Proportionate Interest (%) for Units |
|--------|--------|------------|-----------------|--------------------|--------------------------------------|
| 4N     | 120    | 4          | 1294            | First              | 0.363777%                            |
| 4N     | 121    | 4          | 1073            | First              | 0.427973%                            |
| 4N     | 122    | 4          | 1297            | First              | 0.427973%                            |
| 4N     | 123    | 4          | 1057            | First              | 0.363777%                            |
| 4N     | 124    | 4          | 1149            | First              | 0.427973%                            |
| 4N     | 125    | 4          | 1149            | First              | 0.427973%                            |
| 4E     | 201    | 4          | 1108            | Second             | 0.427973%                            |
| 4E     | 202    | 4          | 1113            | Second             | 0.427973%                            |
| 4E     | 203    | 4          | 1020            | Second             | 0.427973%                            |
| 4E     | 204    | 4          | 1253            | Second             | 0.427973%                            |
| 4E     | 205    | 4          | 1035            | Second             | 0.363777%                            |
| 4E     | 206    | 4          | 1255            | Second             | 0.363777%                            |
| 4E     | 207    | 4          | 1035            | Second             | 0.427973%                            |
| 4E     | 208    | 4          | 1271            | Second             | 0.427973%                            |
| 4E     | 209    | 4          | 1255            | Second             | 0.363777%                            |
| 4E     | 210    | 4          | 1256            | Second             | 0.427973%                            |
| 4E     | 211    | 4          | 1255            | Second             | 0.427973%                            |
| 4E     | 212    | 3          | 738             | Second             | 0.333017%                            |
| 4N     | 213    | 4          | 1304            | Second             | 0.427973%                            |
| 4N     | 214    | 2          | 1369            | Second             | 0.334354%                            |
| 4N     | 215    | 4          | 1179            | Second             | 0.427973%                            |
| 4N     | 216    | 4          | 1261            | Second             | 0.363777%                            |
| 4N     | 217    | 4          | 1230            | Second             | 0.427973%                            |
| 4N     | 218    | 4          | 1227            | Second             | 0.363777%                            |
| 4N     | 219    | 4          | 1033            | Second             | 0.363777%                            |
| 4N     | 220    | 4          | 1269            | Second             | 0.427973%                            |
| 4N     | 221    | 4          | 1033            | Second             | 0.427973%                            |
| 4N     | 222    | 4          | 1255            | Second             | 0.363777%                            |
| 4N     | 223    | 4          | 1036            | Second             | 0.427973%                            |
| 4N     | 224    | 4          | 1255            | Second             | 0.427973%                            |
| 4N     | 225    | 4          | 1112            | Second             | 0.427973%                            |
| 4N     | 226    | 4          | 1111            | Second             | 0.427973%                            |
| 4E     | 301    | 4          | 1110            | Third              | 0.427973%                            |
| 4E     | 302    | 4          | 1110            | Third              | 0.427973%                            |

| Bldg # | Unit # | # of Rooms | Approx. Sq. Ft. | Location/ Floor(s) | Proportionate Interest (%) for Units |
|--------|--------|------------|-----------------|--------------------|--------------------------------------|
| 4E     | 303    | 4          | 1020            | Third              | 0.363777%                            |
| 4E     | 304    | 4          | 1259            | Third              | 0.427973%                            |
| 4E     | 305    | 4          | 1035            | Third              | 0.427973%                            |
| 4E     | 306    | 4          | 1259            | Third              | 0.427973%                            |
| 4E     | 307    | 4          | 1043            | Third              | 0.363777%                            |
| 4E     | 308    | 4          | 1271            | Third              | 0.427973%                            |
| 4E     | 309    | 4          | 1255            | Third              | 0.427973%                            |
| 4E     | 310    | 4          | 1256            | Third              | 0.363777%                            |
| 4E     | 311    | 4          | 1254            | Third              | 0.427973%                            |
| 4E     | 312    | 3          | 741             | Third              | 0.334354%                            |
| 4N     | 313    | 4          | 1304            | Third              | 0.427973%                            |
| 4N     | 314    | 2          | 1369            | Third              | 0.334354%                            |
| 4N     | 315    | 4          | 1179            | Third              | 0.427973%                            |
| 4N     | 316    | 4          | 1264            | Third              | 0.363777%                            |
| 4N     | 317    | 4          | 1230            | Third              | 0.427973%                            |
| 4N     | 318    | 4          | 1225            | Third              | 0.427973%                            |
| 4N     | 319    | 4          | 1034            | Third              | 0.363777%                            |
| 4N     | 320    | 4          | 1269            | Third              | 0.427973%                            |
| 4N     | 321    | 4          | 1034            | Third              | 0.427973%                            |
| 4N     | 322    | 4          | 1260            | Third              | 0.427973%                            |
| 4N     | 323    | 4          | 1037            | Third              | 0.363777%                            |
| 4N     | 324    | 4          | 1258            | Third              | 0.427973%                            |
| 4N     | 325    | 4          | 1112            | Third              | 0.427973%                            |
| 4N     | 326    | 4          | 1112            | Third              | 0.427973%                            |
| 1      | 101    | 4          | 1154            | First              | 0.363777%                            |
| 1      | 102    | 4          | 1156            | First              | 0.427973%                            |
| 1      | 103    | 3          | 855             | First              | 0.334354%                            |
| 1      | 104    | 3          | 852             | First              | 0.333017%                            |
| 1      | 105    | 3          | 852             | First              | 0.333017%                            |
| 1      | 106    | 4          | 1074            | First              | 0.427973%                            |

| Bldg # | Unit # | # of Rooms | Approx. Sq. Ft. | Location/ Floor(s) | Proportionate Interest (%) for Units |
|--------|--------|------------|-----------------|--------------------|--------------------------------------|
| 1      | 107    | 3          | 849             | First              | 0.334354%                            |
| 1      | 108    | 4          | 1079            | First              | 0.427973%                            |
| 1      | 109    | 3          | 851             | First              | 0.333017%                            |
| 1      | 110    | 3          | 852             | First              | 0.333017%                            |
| 1      | 111    | 3          | 857             | First              | 0.334354%                            |
| 1      | 112    | 4          | 1155            | First              | 0.427973%                            |
| 1      | 113    | 4          | 1154            | First              | 0.427973%                            |
| 1      | 201    | 4          | 1115            | Second             | 0.427973%                            |
| 1      | 202    | 4          | 1115            | Second             | 0.427973%                            |
| 1      | 203    | 4          | 1035            | Second             | 0.363777%                            |
| 1      | 204    | 4          | 1271            | Second             | 0.427973%                            |
| 1      | 205    | 3          | 812             | Second             | 0.334354%                            |
| 1      | 206    | 4          | 1035            | Second             | 0.427973%                            |
| 1      | 207    | 3          | 850             | Second             | 0.333017%                            |
| 1      | 208    | 4          | 1034            | Second             | 0.427973%                            |
| 1      | 209    | 3          | 813             | Second             | 0.334354%                            |
| 1      | 210    | 4          | 1261            | Second             | 0.427973%                            |
| 1      | 211    | 4          | 1032            | Second             | 0.363777%                            |
| 1      | 212    | 4          | 1121            | Second             | 0.427973%                            |
| 1      | 213    | 4          | 1118            | Second             | 0.427973%                            |
| 1      | 301    | 4          | 1120            | Third              | 0.427973%                            |
| 1      | 302    | 4          | 1118            | Third              | 0.427973%                            |
| 1      | 303    | 4          | 1037            | Third              | 0.363777%                            |
| 1      | 304    | 4          | 1263            | Third              | 0.427973%                            |
| 1      | 305    | 4          | 1250            | Third              | 0.427973%                            |
| 1      | 306    | 4          | 1034            | Third              | 0.427973%                            |
| 1      | 307    | 4          | 1253            | Third              | 0.363777%                            |
| 1      | 308    | 4          | 1038            | Third              | 0.427973%                            |
| 1      | 309    | 4          | 1033            | Third              | 0.427973%                            |
| 1      | 310    | 4          | 1264            | Third              | 0.427973%                            |

| Bldg # | Unit # | # of Rooms | Approx. Sq. Ft. | Location/ Floor(s)                                  | Proportionate Interest (%) for Units |
|--------|--------|------------|-----------------|---|--------------------------------------|
| 1      | 311    | 4          | 1117            | Third   | 0.363777%                            |
| 1      | 312    | 4          | 1121            | Third   | 0.427973%                            |
| 16     | 1601   | 4          | 1998            | 1 <sup>st</sup> , 2 <sup>nd</sup>                   | 0.561715%                            |
| 16     | 1602   | 5          | 2109            | 1 <sup>st</sup> , 2 <sup>nd</sup> , 3 <sup>rd</sup> | 0.561715%                            |
| 16     | 1603   | 5          | 2366            | 1 <sup>st</sup> , 2 <sup>nd</sup> , 3 <sup>rd</sup> | 0.561715%                            |
| 16     | 1604   | 5          | 2111            | 1 <sup>st</sup> , 2 <sup>nd</sup> , 3 <sup>rd</sup> | 0.397213%                            |
| 16     | 1605   | 5          | 2114            | 1 <sup>st</sup> , 2 <sup>nd</sup> , 3 <sup>rd</sup> | 0.561715%                            |
| 16     | 1606   | 6          | 2180            | 1 <sup>st</sup> , 2 <sup>nd</sup>                   | 0.561715%                            |
| 17     | 1701   | 7          | 2764            | 1 <sup>st</sup> , 2 <sup>nd</sup> , 3 <sup>rd</sup> | 0.561715%                            |
| 17     | 1702   | 6          | 2264            | 1 <sup>st</sup> , 2 <sup>nd</sup> , 3 <sup>rd</sup> | 0.397213%                            |
| 17     | 1703   | 6          | 2283            | 1 <sup>st</sup> , 2 <sup>nd</sup> , 3 <sup>rd</sup> | 0.561715%                            |
|        |        |            |                 |   | <b>100.000000%</b>                   |

Immediate common areas to which each Unit has access are the common hallways or Building exterior, as shown on the Floor Plans.

**ELEVENTH AMENDMENT TO MASTER DEED OF  
OAKRIDGE VILLAGE - MAPLEWOOD RESERVE**

**ADDITION OF PHASE 11  
(BUILDING 19)**

VRD ACQUISITION, LLC, a Massachusetts limited liability company with a place of business at 100 Andover By-Pass, North Andover, Massachusetts 01845 being the successor Declarant by deed dated September 1, 2009 and recorded at Book 11757, Page 4 under a Master Deed dated March 14, 2006 and recorded with Essex North District Registry of Deeds (the "Registry") at Book 10082, Page 1, as amended by First Amendment to Master Deed dated April 13, 2006 and recorded with the Registry at Book 10128, Page 127 (the "First Amendment"), Second Amendment to Master Deed dated April 19, 2006 and recorded with the Registry at Book 10140, Page 147, Third Amendment to Master Deed dated June 30, 2006 and recorded with the Registry at Book 10285, Page 169, Fourth Amendment to Master Deed dated August 16, 2006 and recorded with the Registry at Book 10356, Page 32, Fifth Amendment to Master Deed dated October 10, 2006 and recorded with the Registry at Book 10443, Page 137 and Sixth Amendment to Master Deed dated October 23, 2006 and recorded with the Registry at Book 10468, Page 39 and Seventh Amendment to Master Deed dated March 14, 2007 and recorded with the Registry in Book 10667, Page 281 and Eight Amendment to Master Deed dated October 19, 2007 and recorded with the Registry at Book 10947, Page 268 and Ninth Amendment to Master Deed dated July 9, 2010 and recorded with the Registry at Book 12103, Page 214 and Tenth Amendment to Master Deed dated November 12, 2010 and recorded with the Registry at Book 12279, Page 147 (the "Master Deed"), pursuant to the rights reserved in paragraphs 14 and 18 of the Master Deed to amend the Master Deed, including the right to add additional phases, does hereby amend the Master Deed as contained herein, including the addition of Phase Eleven (Building 19) to the Condominium. Capitalized terms used but not defined in this Amendment shall have the same definitions given to them in the Master Deed.

1. Phase 11 consists of Building 19 containing six (6) garage spaces;
2. The Master Deed is hereby amended as follows:
  - (a) Paragraph 5 of the Master Deed is hereby amended by deleting the existing Condominium Site Plan(s) and substituting it with a certain plans depicting the Garage building and designated spaces entitled "Condominium Site Plan - Phase XI, Oakridge Village / Maplewood Reserve, North Andover, Mass. Drawn for Valley Realty Development, LLC", dated: April 27, 2011, by Merrimack Engineering Services and recorded with the Registry as Plan Nos. \_\_\_\_\_.
  - (b) The Garage spaces for Phase 11 (Building 19) are shown on the plans entitled "Project: Maplewood Reserve Building 19, Six Bay Garage Structure, North Andover, MA 01845, Garage Plan" prepared by Vorbach Architecture and recorded with the Registry as Plan Nos. \_\_\_\_\_ and the Plans described in Paragraph 6(a) of the Master Deed are hereby amended to include the above-described plans.
  - (c) Exhibit B to the Master Deed is hereby amended by deleting the existing Exhibit B and substituting it with the Exhibit B attached hereto and made a part hereof.

3. Giving effect to the foregoing, Phase 11 (Building 19) is hereby added to the Condominium.
4. Except as hereby amended, the Master Deed is ratified and confirmed in all respects.

IN WITNESS WHEREOF, the said VRD Acquisition, LLC has caused these presents to be executed this 21 day of April, 2011.

VRD Acquisition, LLC

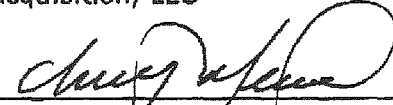
By: 

Name: Anthony Mesiti  
Manager

**EXHIBIT B****DESCRIPTION OF BUILDINGS**

There are Eighteen (18) Buildings on the Land described in Exhibit A to this Master Deed contained in phases 1, 2, 3, 4, 5, 6, 7, 8, 9, 10 and 11 of the Condominium. Said Buildings are described as follows:

1. A one (1) story community building containing an indoor swimming pool, shown on the Condominium Site Plan as "1 Story Community Building #5, #5 Harvest Drive".
2. A three (3) story building consisting of thirty eight (38) residential Units shown on the Condominium Site Plan as "3 Story 38 Unit Building #2, #2 Harvest Drive." Said building contains Unit 101 through 312.
3. A two and one-half (2 1/2) story building consisting of twelve (12) residential Townhouse Units and one (1) Garage shown on the Condominium Site Plan as "2 1/2 Story 12 Unit Building #6 601-612 Alder Way." Said building contains Units 601-612.
4. A one (1) story building consisting of five (5) Garages shown on the Condominium Site Plan as "1 Story 5 Car Garage Building #7".
5. A one (1) story building consisting of six (6) Garages shown on the Condominium Site Plan as "1 Story 6 Car Garage Building #8".
6. A three (3) story building consisting of thirty eight (38) residential Units and forty (40) Indoor Parking Spaces, shown on the Condominium Site Plan as "3 Story 38 Unit Building #3, #3 Harvest Drive". Said building contains Units 101 through 312.
7. A two and one-half (2 1/2) story building consisting of six (6) residential Townhouse Units and one (1) Garage shown on the Condominium Site Plan as "2 1/2 Story 6 Unit Building #9 901-906 Alder Way". Said building contains Unit 901 through 906.
8. A one (1) story building consisting of nine (9) Garages shown on the Condominium site Plan as "1 Story 9 Car Garage Building #10".
9. A two and one-half (2 1/2) story building consisting of six (6) residential Townhouse Units shown on the Condominium Site Plan as "2 1/2 Story 6 Unit Building #11 1101-1106 Acorn Drive". Said building contains Unit 1101 through 1106.
10. A one (1) story building consisting of six (6) Garages shown on the Condominium Site Plan as "1 Story 6 Car Garage Building #12".
11. A two and one-half (2 1/2) story building consisting of six (6) residential Townhouse Units and three (3) Garages shown on the Condominium Site Plan as "2 1/2 Story 6 Unit Building #13 1301-1306 Basswood Circle". Said building contains Unit 1301 through 1306.
12. A two and one-half (2 1/2) story building consisting of five (5) residential Townhouse Units and four (4) Garages shown on the Condominium Site Plan as "2 1/2 Story 6 Unit Building #14 1401-1405 Basswood Circle". Said building contains Units 1401 through 1405.
13. A two and one-half (2 1/2) story building consisting of three (3) residential Townhouse Units and three (3) Garages shown on the Condominium Site Plan as "2 1/2 Story 6 Unit Building #15 1501-1503 Basswood Circle". Said building contains Units 1501 through 1503.
14. A three (3) story building consisting of two sections (4N and 4E) containing a total of seventy seven (77) residential Units and eighty four (84) Indoor Parking Spaces. 4N is shown on the Condominium Site Plan as "3 Story 36 Unit Building #4N, #4 Harvest Drive" and 4E is shown on the Condominium Site Plan as "3 Story 36 Unit Building #4E, #4 Harvest Drive". Said Building 4E contains Units 101 through 112, 201

- through 212, and Units 301 through 312 and building 4N contains Units 113 through 125, 213 through 226 and 313 through 326.
15. A three (3) story building consisting of thirty (38) residential Units, shown on the Condominium Site Plan as "3 Story 38 Unit Building #1, #1 Harvest Drive". Said building contains Units 101 through 312.
  16. A two and one-half (2 ½) story building consisting of six (6) residential Units and five (5) Garages shown on the Condominium Site Plan as "2 ½ Story Building #16".
  17. A two and one-half (2 ½) story building consisting of three (3) residential Units shown on the Condominium Site Plan as "2 ½ Story Building #17".
  18. A one story building consisting of six (6) garages spaces shown on the Condominium Site Plan as "1 Story W.F Garage Building #19".

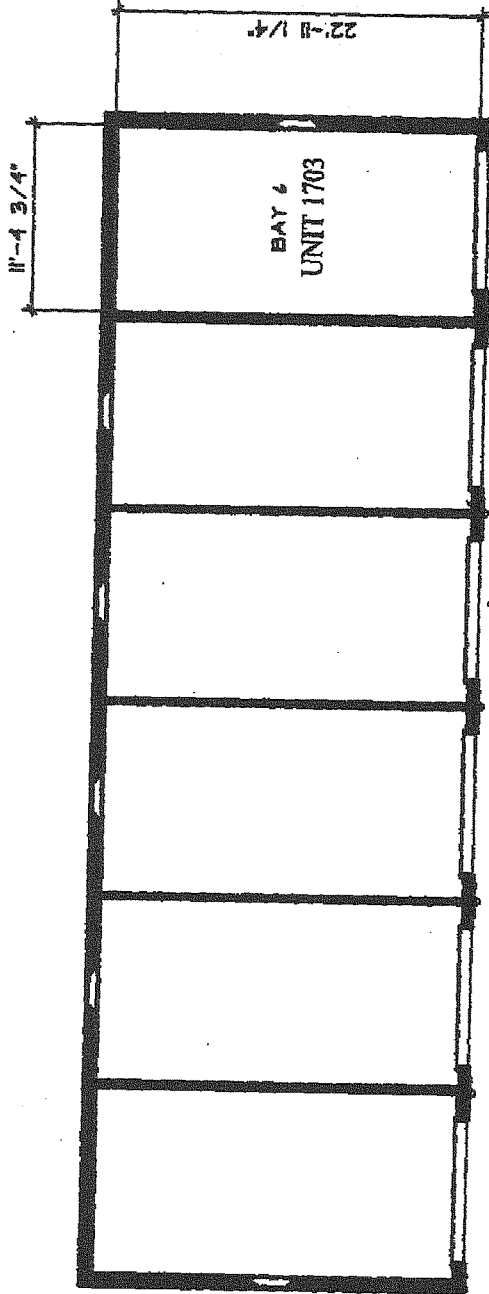

GARAGE PLAN

**GARAGE BAY 6  
UNIT 1703**

AREA = 292 S.F.

MA. SEAL 9085:

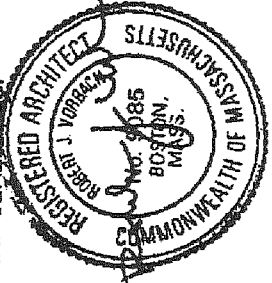

I HEREBY CERTIFY THAT THE WITHIN PLAN OF BAY NO. 6 (UNIT 1703) OF PHASE 11 - BUILDING 19 IN THE OAKRIDGE VILLAGE/MAPLEWOOD RESERVE CONDOMINIUMS SHOWS THE UNIT DESIGNATION OF THE UNIT BEING CONVEYED AND OF IMMEDIATELY ADJOINING UNITS AND THAT IT FULLY AND ACCURATELY DEPICTS THE LAYOUT OF THE UNIT, ITS LOCATION, DIMENSIONS, APPROXIMATE AREA, MAIN ENTRANCE AND IMMEDIATE COMMON AREA TO WHICH IT HAS ACCESS, AS BUILT.

**CONDOMINIUM UNIT PLAN**  
 PHASE 11 - BUILDING 19  
 OAKRIDGE VILLAGE / MAPLEWOOD RESERVE  
 DOGWOOD CIRCLE  
 NORTH ANDOVER, MASSACHUSETTS 01845  
 AS DRAWN FOR:  
 VED ACQUISITIONS, LLC  
 100 ANDOVER BYPASS, SUITE 103  
 NORTH ANDOVER, MASS. 01845

DATE: APRIL 28, 2011 SCALE: 3/32" = 1'-0"

**VORBACH ARCHITECTURE**  
 56 Manchester Street, North, N.H. 03064-2114  
 ROBERT J. VORBACH  
 REGISTERED ARCHITECT  
 Tel: 603 • 868 • 1738 Fax: 603 • 868 • 1736

**TWELFTH AMENDMENT TO MASTER DEED OF  
OAKRIDGE VILLAGE - MAPLEWOOD RESERVE**

**ADDITION OF PHASE 12  
(BUILDING 18)**

VRD ACQUISITION, LLC, a Massachusetts limited liability company with a place of business at 100 Andover By-Pass, North Andover, Massachusetts 01845 being the successor Declarant by deed dated September 1, 2009 and recorded at Book 11757, Page 4 under a Master Deed dated March 14, 2006 and recorded with Essex North District Registry of Deeds (the "Registry") at Book 10082, Page 1, as amended by First Amendment to Master Deed dated April 13, 2006 and recorded with the Registry at Book 10128, Page 127 (the "First Amendment"), Second Amendment to Master Deed dated April 19, 2006 and recorded with the Registry at Book 10140, Page 147, Third Amendment to Master Deed dated June 30, 2006 and recorded with the Registry at Book 10285, Page 169, Fourth Amendment to Master Deed dated August 16, 2006 and recorded with the Registry at Book 10356, Page 32, Fifth Amendment to Master Deed dated October 10, 2006 and recorded with the Registry at Book 10443, Page 137 and Sixth Amendment to Master Deed dated October 23, 2006 and recorded with the Registry at Book 10468, Page 39 and Seventh Amendment to Master Deed dated March 14, 2007 and recorded with the Registry in Book 10667, Page 281 and Eight Amendment to Master Deed dated October 19, 2007 and recorded with the Registry at Book 10947, Page 268 and Ninth Amendment to Master Deed dated July 9, 2010 and recorded with the Registry at Book 12103, Page 214 and Tenth Amendment to Master Deed dated November 12, 2010 and recorded with the Registry at Book 12279, Page 147 and Eleventh Amendment to Master Deed dated April 29, 2011 and recorded with the Registry at Book 12475, Page 170 (the "Master Deed"), pursuant to the rights reserved in paragraphs 14 and 18 of the Master Deed to amend the Master Deed, including the right to add additional phases, does hereby amend the Master Deed as contained herein, including the addition of Phase Twelve (Building 18) to the Condominium. Capitalized terms used but not defined in this Amendment shall have the same definitions given to them in the Master Deed.

1. Phase 12 consists of Building 18 containing six (6) townhouse units;
2. The Master Deed is hereby amended as follows:
  - (a) Paragraph 5 of the Master Deed is hereby amended by deleting the existing Condominium Site Plan(s) and substituting it with a certain plans entitled "Condominium Site Plan - Phase XII, Oakridge Village / Maplewood Reserve, North Andover, Mass. Drawn for VRD Acquisition, LLC", dated: June 14, 2011, by Merrimack Engineering Services and recorded with the Registry as Plan Nos. 16478.
  - (b) The Units for Phase 12 (Building 18) are shown on the plans entitled "Project: Maplewood Reserve Building 18 1801-1806 Dogwood Circle, North Andover, Mass." dated, June 3, 2011, containing Sheets 1 through 3, prepared by Vorbach Architecture in accordance with Section 8(f) of the Act and recorded with the Registry as Plan Nos. 16479 and the Floor Plans described in Paragraph 6(a) of the Master Deed, are hereby amended to include the above-described plans.
  - (c) Exhibit B to the Master Deed is hereby amended by deleting the existing Exhibit B and substituting it with the Exhibit B attached hereto and made a

part hereof.

- (d) Exhibit C to the Master Deed is hereby amended by deleting the existing Exhibit C and substituting it with the Exhibit C attached hereto and made a part hereof.
- 3. Giving effect to the foregoing, Phase 12 (Building 18) is hereby added to the Condominium.
- 4. Except as hereby amended, the Master Deed is ratified and confirmed in all respects.

IN WITNESS WHEREOF, the said VRD Acquisition, LLC has caused these presents to be executed this 17 day of June, 2011.

VRD Acquisition, LLC

By: 

Name: Anthony Meski  
Manager

**EXHIBIT B****DESCRIPTION OF BUILDINGS**

There are Eighteen (18) Buildings on the Land described in Exhibit A to this Master Deed contained in phases 1, 2, 3, 4, 5, 6, 7, 8, 9, 10 and 11 of the Condominium. Said Buildings are described as follows:

1. A one (1) story community building containing an indoor swimming pool, shown on the Condominium Site Plan as "1 Story Community Building #5, #5 Harvest Drive".
2. A three (3) story building consisting of thirty eight (38) residential Units shown on the Condominium Site Plan as "3 Story 38 Unit Building #2, #2 Harvest Drive." Said building contains Unit 101 through 312.
3. A two and one-half (2 1/2) story building consisting of twelve (12) residential Townhouse Units and one (1) Garage shown on the Condominium Site Plan as "2 1/2 Story 12 Unit Building #6 601-612 Alder Way." Said building contains Units 601-612.
4. A one (1) story building consisting of five (5) Garages shown on the Condominium Site Plan as "1 Story 5 Car Garage Building #7".
5. A one (1) story building consisting of six (6) Garages shown on the Condominium Site Plan as "1 Story 6 Car Garage Building #8".
6. A three (3) story building consisting of thirty eight (38) residential Units and forty (40) Indoor Parking Spaces, shown on the Condominium Site Plan as "3 Story 38 Unit Building #3, #3 Harvest Drive". Said building contains Units 101 through 312.
7. A two and one-half (2 1/2) story building consisting of six (6) residential Townhouse Units and one (1) Garage shown on the Condominium Site Plan as "2 1/2 Story 6 Unit Building #9 901-906 Alder Way". Said building contains Unit 901 through 906.
8. A one (1) story building consisting of nine (9) Garages shown on the Condominium site Plan as "1 Story 9 Car Garage Building #10".
9. A two and one-half (2 1/2) story building consisting of six (6) residential Townhouse Units shown on the Condominium Site Plan as "2 1/2 Story 6 Unit Building #11 1101-1106 Acorn Drive". Said building contains Unit 1101 through 1106.
10. A one (1) story building consisting of six (6) Garages shown on the Condominium Site Plan as "1 Story 6 Car Garage Building #12".
11. A two and one-half (2 1/2) story building consisting of six (6) residential Townhouse Units and three (3) Garages shown on the Condominium Site Plan as "2 1/2 Story 6 Unit Building #13 1301-1306 Basswood Circle". Said building contains Unit 1301 through 1306.
12. A two and one-half (2 1/2) story building consisting of five (5) residential Townhouse Units and four (4) Garages shown on the Condominium Site Plan as "2 1/2 Story 6 Unit Building #14 1401-1405 Basswood Circle". Said building contains Units 1401 through 1405.
13. A two and one-half (2 1/2) story building consisting of three (3) residential Townhouse Units and three (3) Garages shown on the Condominium Site Plan as "2 1/2 Story 6 Unit Building #15 1501-1503 Basswood Circle". Said building contains Units 1501 through 1503.
14. A three (3) story building consisting of two sections (4N and 4E) containing a total of seventy seven (77) residential Units and eighty four (84) Indoor Parking Spaces. 4N is shown on the Condominium Site Plan as "3 Story 36 Unit Building #4N, #4 Harvest Drive" and 4E is shown on the Condominium Site Plan as "3 Story 36 Unit Building

- #4E, #4 Harvest Drive". Said Building 4E contains Units 101 through 112, 201 through 212, and Units 301 through 312 and building 4N contains Units 113 through 125, 213 through 226 and 313 through 326.
15. A three (3) story building consisting of thirty (38) residential Units, shown on the Condominium Site Plan as "3 Story 38 Unit Building #1, #1 Harvest Drive". Said building contains Units 101 through 312.
  16. A two and one-half (2 ½) story building consisting of six (6) residential Units and five (5) Garages shown on the Condominium Site Plan as "2 ½ Story Building #16".
  17. A two and one-half (2 ½) story building consisting of three (3) residential Units shown on the Condominium Site Plan as "2 ½ Story Building #17".
  18. A one story building consisting of six (6) garages spaces shown on the Condominium Site Plan as "1 Story six car Garage Building #19".
  19. A two (2) story building consisting of six (6) residential units, shown on the Condominium Site Plan as "2 Story W.F. Building #18".

**EXHIBIT C  
DESCRIPTION OF UNITS**

| Bldg # <sup>1</sup> | Unit # | # of Rooms <sup>2</sup> | Approx. Sq. Ft. <sup>3</sup> | Location/<br>Floor(s) | Proportionate Interest (%) for Units |
|---------------------|--------|-------------------------|------------------------------|-----------------------|--------------------------------------|
| 2                   | 101    | 4                       | 1154                         | First                 | 0.414020%                            |
| 2                   | 102    | 4                       | 1159                         | First                 | 0.414020%                            |
| 2                   | 103    | 3                       | 860                          | First                 | 0.323453%                            |
| 2                   | 104    | 3                       | 852                          | First                 | 0.322159%                            |
| 2                   | 105    | 3                       | 856                          | First                 | 0.322159%                            |
| 2                   | 106    | 4                       | 1077                         | First                 | 0.414020%                            |
| 2                   | 107    | 3                       | 852                          | First                 | 0.323453%                            |
| 2                   | 108    | 4                       | 1077                         | First                 | 0.414020%                            |
| 2                   | 109    | 3                       | 855                          | First                 | 0.322159%                            |
| 2                   | 110    | 3                       | 852                          | First                 | 0.322159%                            |
| 2                   | 111    | 3                       | 859                          | First                 | 0.323453%                            |
| 2                   | 112    | 4                       | 1159                         | First                 | 0.414020%                            |
| 2                   | 113    | 4                       | 1152                         | First                 | 0.414020%                            |
| 2                   | 201    | 4                       | 1116                         | Second                | 0.414020%                            |
| 2                   | 202    | 4                       | 1117                         | Second                | 0.414020%                            |
| 2                   | 203    | 4                       | 1039                         | Second                | 0.351917%                            |
| 2                   | 204    | 4                       | 1259                         | Second                | 0.414020%                            |
| 2                   | 205    | 3                       | 814                          | Second                | 0.323453%                            |
| 2                   | 206    | 4                       | 1035                         | Second                | 0.351917%                            |

<sup>1</sup> As shown on the Condominium Site Plan. The post office address for : (i) Building 1 is 1 Harvest Drive, North Andover, MA 01845; (ii) Building 2 is 2 Harvest Drive, North Andover, MA 01845; (iii) Building 6 is 601-612 Alder Way, North Andover, MA 01845; (iv) Building 3 is 3 Harvest Drive, North Andover, MA 01845; (v) Building 9 is 901-906 Alder Way, North Andover, MA 01845; (vi) Building 11 is 1101-1106 Acorn Drive, North Andover, MA 01845; (vii) Building 13 is 1301-1306 Basswood Circle, North Andover, MA 01845; (viii) Building 14 is 1401-1405 Basswood Circle, North Andover, MA 01845; (ix) Building 15 is 1501-1503 Basswood Circle, North Andover, MA 01845; (x) Building 4N and 4E are 4 Harvest Drive, North Andover, MA 01845; (xi) Building 1 is 1 Harvest Drive, North Andover, MA 01845; (xii) Building 16 is 1601-1606 Catalpa Drive, North Andover, MA 01845 (xiii) Building 17 is 1701-1703 Dogwood Circle, North Andover, MA 01845 (xii) Building 18 is 1801-1806 Dogwood Circle, North Andover, MA 01845

<sup>2</sup> Closets, Mechanical Closets, Mechanical rooms, Bathrooms, Balconies and Decks are not included in the number of rooms in the column headed # of Rooms.

<sup>3</sup> The approximate area of the Unit in square feet set forth does not include any balcony or deck.

| Bldg # | Unit # | # of Rooms | Approx. Sq. Ft. | Location/<br>Floor(s)                               | Proportionate Interest (%) for Units |
|--------|--------|------------|-----------------|---|--------------------------------------|
| 2      | 207    | 3          | 857             | Second  | 0.322159%                            |
| 2      | 208    | 4          | 1036            | Second  | 0.414020%                            |
| 2      | 209    | 3          | 813             | Second  | 0.323453%                            |
| 2      | 210    | 4          | 1261            | Second  | 0.414020%                            |
| 2      | 211    | 4          | 1032            | Second  | 0.351917%                            |
| 2      | 212    | 4          | 1117            | Second  | 0.414020%                            |
| 2      | 213    | 4          | 1118            | Second  | 0.414020%                            |
| 2      | 301    | 4          | 1121            | Third   | 0.414020%                            |
| 2      | 302    | 4          | 1118            | Third   | 0.414020%                            |
| 2      | 303    | 4          | 1043            | Third   | 0.351917%                            |
| 2      | 304    | 4          | 1267            | Third   | 0.414020%                            |
| 2      | 305    | 4          | 1257            | Third   | 0.414020%                            |
| 2      | 306    | 4          | 1031            | Third   | 0.351917%                            |
| 2      | 307    | 4          | 1257            | Third   | 0.414020%                            |
| 2      | 308    | 4          | 1038            | Third   | 0.414020%                            |
| 2      | 309    | 4          | 1035            | Third   | 0.414020%                            |
| 2      | 310    | 4          | 1264            | Third   | 0.414020%                            |
| 2      | 311    | 4          | 1117            | Third   | 0.351917%                            |
| 2      | 312    | 4          | 1121            | Third   | 0.414020%                            |
| 6      | 601    | 6          | 1912            | 1 <sup>st</sup> , 2 <sup>nd</sup> , 3 <sup>rd</sup> | 0.543401%                            |
| 6      | 602    | 5          | 1911            | 1 <sup>st</sup> , 2 <sup>nd</sup> , 3 <sup>rd</sup> | 0.543401%                            |
| 6      | 603    | 5          | 1904            | 1 <sup>st</sup> , 2 <sup>nd</sup> , 3 <sup>rd</sup> | 0.543401%                            |
| 6      | 604    | 6          | 1919            | 1 <sup>st</sup> , 2 <sup>nd</sup> , 3 <sup>rd</sup> | 0.543401%                            |
| 6      | 605    | 6          | 2044            | 1 <sup>st</sup> , 2 <sup>nd</sup> , 3 <sup>rd</sup> | 0.543401%                            |
| 6      | 606    | 6          | 1916            | 1 <sup>st</sup> , 2 <sup>nd</sup> , 3 <sup>rd</sup> | 0.543401%                            |
| 6      | 607    | 5          | 1909            | 1 <sup>st</sup> , 2 <sup>nd</sup> , 3 <sup>rd</sup> | 0.543401%                            |
| 6      | 608    | 5          | 1911            | 1 <sup>st</sup> , 2 <sup>nd</sup> , 3 <sup>rd</sup> | 0.384262%                            |
| 6      | 609    | 5          | 1905            | 1 <sup>st</sup> , 2 <sup>nd</sup> , 3 <sup>rd</sup> | 0.543401%                            |
| 6      | 610    | 5          | 1911            | 1 <sup>st</sup> , 2 <sup>nd</sup> , 3 <sup>rd</sup> | 0.384262%                            |
| 6      | 611    | 6          | 1908            | 1 <sup>st</sup> , 2 <sup>nd</sup> , 3 <sup>rd</sup> | 0.543401%                            |
| 6      | 612    | 7          | 1905            | 1 <sup>st</sup> , 2 <sup>nd</sup>                   | 0.543401%                            |
| 3      | 101    | 4          | 1149            | First   | 0.414020%                            |
| 3      | 102    | 4          | 1155            | First   | 0.414020%                            |
| 3      | 103    | 4          | 1054            | First   | 0.414020%                            |
| 3      | 104    | 3          | 859             | First   | 0.322159%                            |
| 3      | 105    | 3          | 850             | First   | 0.322159%                            |
| 3      | 106    | 4          | 1080            | First   | 0.414020%                            |
| 3      | 107    | 3          | 847             | First   | 0.323453%                            |
| 3      | 108    | 4          | 1079            | First   | 0.414020%                            |
| 3      | 109    | 3          | 854             | First   | 0.322159%                            |
| 3      | 110    | 3          | 858             | First   | 0.322159%                            |

| Bldg # | Unit # | # of Rooms | Approx. Sq. Ft. | Location/ Floor(s)                                  | Proportionate Interest (%) for Units |
|--------|--------|------------|-----------------|---|--------------------------------------|
| 3      | 111    | 4          | 1051            | First   | 0.414020%                            |
| 3      | 112    | 4          | 1150            | First   | 0.414020%                            |
| 3      | 113    | 4          | 1152            | First   | 0.414020%                            |
| 3      | 201    | 4          | 1116            | Second  | 0.414020%                            |
| 3      | 202    | 4          | 1114            | Second  | 0.414020%                            |
| 3      | 203    | 4          | 1029            | Second  | 0.351917%                            |
| 3      | 203    | 4          | 1029            | Second  | 0.363777%                            |
| 3      | 204    | 4          | 1264            | Second  | 0.414020%                            |
| 3      | 205    | 3          | 809             | Second  | 0.323453%                            |
| 3      | 206    | 4          | 1034            | Second  | 0.351917%                            |
| 3      | 207    | 3          | 848             | Second  | 0.322159%                            |
| 3      | 208    | 4          | 1035            | Second  | 0.414020%                            |
| 3      | 209    | 3          | 806             | Second  | 0.323453%                            |
| 3      | 210    | 4          | 1264            | Second  | 0.414020%                            |
| 3      | 211    | 4          | 1026            | Second  | 0.351917%                            |
| 3      | 212    | 4          | 1115            | Second  | 0.414020%                            |
| 3      | 213    | 4          | 1111            | Second  | 0.414020%                            |
| 3      | 301    | 4          | 1112            | Third   | 0.414020%                            |
| 3      | 302    | 4          | 1114            | Third   | 0.414020%                            |
| 3      | 303    | 4          | 1030            | Third   | 0.351917%                            |
| 3      | 304    | 4          | 1267            | Third   | 0.414020%                            |
| 3      | 305    | 4          | 1243            | Third   | 0.414020%                            |
| 3      | 306    | 4          | 1058            | Third   | 0.351917%                            |
| 3      | 307    | 4          | 1243            | Third   | 0.414020%                            |
| 3      | 308    | 4          | 1042            | Third   | 0.414020%                            |
| 3      | 309    | 4          | 1028            | Third   | 0.414020%                            |
| 3      | 310    | 4          | 1270            | Third   | 0.414020%                            |
| 3      | 311    | 4          | 1107            | Third   | 0.414020%                            |
| 3      | 312    | 4          | 1120            | Third   | 0.414020%                            |
| 9      | 901    | 6          | 1896            | 1 <sup>st</sup> , 2 <sup>nd</sup> , 3 <sup>rd</sup> | 0.543401%                            |
| 9      | 902    | 5          | 1918            | 1 <sup>st</sup> , 2 <sup>nd</sup> , 3 <sup>rd</sup> | 0.384262%                            |
| 9      | 903    | 6          | 1912            | 1 <sup>st</sup> , 2 <sup>nd</sup> , 3 <sup>rd</sup> | 0.543401%                            |
| 9      | 904    | 6          | 1912            | 1 <sup>st</sup> , 2 <sup>nd</sup> , 3 <sup>rd</sup> | 0.543401%                            |
| 9      | 905    | 5          | 1916            | 1 <sup>st</sup> , 2 <sup>nd</sup> , 3 <sup>rd</sup> | 0.384262%                            |
| 9      | 906    | 7          | 1905            | 1 <sup>st</sup> , 2 <sup>nd</sup> , 3 <sup>rd</sup> | 0.543401%                            |
| 11     | 1101   | 6          | 1636            | 1 <sup>st</sup> , 2 <sup>nd</sup>                   | 0.543401%                            |
| 11     | 1102   | 5          | 1917            | 1 <sup>st</sup> , 2 <sup>nd</sup> , 3 <sup>rd</sup> | 0.543401%                            |
| 11     | 1103   | 6          | 2106            | 1 <sup>st</sup> , 2 <sup>nd</sup> , 3 <sup>rd</sup> | 0.384262%                            |
| 11     | 1104   | 5          | 1715            | 1 <sup>st</sup> , 2 <sup>nd</sup> , 3 <sup>rd</sup> | 0.543401%                            |
| 11     | 1105   | 5          | 1911            | 1 <sup>st</sup> , 2 <sup>nd</sup> , 3 <sup>rd</sup> | 0.543401%                            |
| 11     | 1106   | 6          | 1646            | 1 <sup>st</sup> , 2 <sup>nd</sup>                   | 0.543401%                            |

| Bldg # | Unit # | # of Rooms | Approx. Sq. Ft. | Location/ Floor(s)                                | Proportionate Interest (%) for Units |
|--------|--------|------------|-----------------|---|--------------------------------------|
| 13     | 1301   | 6          | 1909            | 1 <sup>st</sup> ,2 <sup>nd</sup> ,3 <sup>rd</sup> | 0.543401%                            |
| 13     | 1302   | 5          | 1915            | 1 <sup>st</sup> ,2 <sup>nd</sup> ,3 <sup>rd</sup> | 0.384262%                            |
| 13     | 1303   | 5          | 1917            | 1 <sup>st</sup> ,2 <sup>nd</sup> ,3 <sup>rd</sup> | 0.543401%                            |
| 13     | 1304   | 5          | 1720            | 1 <sup>st</sup> ,2 <sup>nd</sup> ,3 <sup>rd</sup> | 0.384262%                            |
| 13     | 1305   | 6          | 2110            | 1 <sup>st</sup> ,2 <sup>nd</sup> ,3 <sup>rd</sup> | 0.384262%                            |
| 13     | 1306   | 7          | 1936            | 1 <sup>st</sup> , 2 <sup>nd</sup>                 | 0.543401%                            |
| 14     | 1401   | 6          | 2099            | 1 <sup>st</sup> ,2 <sup>nd</sup> ,3 <sup>rd</sup> | 0.384262%                            |
| 14     | 1402   | 5          | 1712            | 1 <sup>st</sup> ,2 <sup>nd</sup> ,3 <sup>rd</sup> | 0.384262%                            |
| 14     | 1403   | 5          | 1907            | 1 <sup>st</sup> ,2 <sup>nd</sup> ,3 <sup>rd</sup> | 0.543401%                            |
| 14     | 1404   | 5          | 1910            | 1 <sup>st</sup> ,2 <sup>nd</sup> ,3 <sup>rd</sup> | 0.384262%                            |
| 14     | 1405   | 6          | 1897            | 1 <sup>st</sup> ,2 <sup>nd</sup> ,3 <sup>rd</sup> | 0.384262%                            |
| 15     | 1501   | 6          | 1896            | 1 <sup>st</sup> ,2 <sup>nd</sup> ,3 <sup>rd</sup> | 0.543401%                            |
| 15     | 1502   | 5          | 1909            | 1 <sup>st</sup> ,2 <sup>nd</sup> ,3 <sup>rd</sup> | 0.384262%                            |
| 15     | 1503   | 5          | 1566            | 1 <sup>st</sup> , 2 <sup>nd</sup>                 | 0.543401%                            |
| 4E     | 101    | 4          | 1146            | First   | 0.414020%                            |
| 4E     | 102    | 4          | 1151            | First   | 0.414020%                            |
| 4E     | 103    | 4          | 1058            | First   | 0.351917%                            |
| 4E     | 104    | 4          | 1295            | First   | 0.414020%                            |
| 4E     | 105    | 4          | 1073            | First   | 0.414020%                            |
| 4E     | 106    | 4          | 1297            | First   | 0.351917%                            |
| 4E     | 107    | 4          | 1074            | First   | 0.414020%                            |
| 4E     | 108    | 3          | 856             | First   | 0.322159%                            |
| 4E     | 109    | 4          | 1296            | First   | 0.414020%                            |
| 4E     | 110    | 4          | 1293            | First   | 0.414020%                            |
| 4E     | 111    | 4          | 1292            | First   | 0.414020%                            |
| 4E     | 112    | 3          | 816             | First   | 0.322159%                            |
| 4N     | 113    | 4          | 1340            | First   | 0.414020%                            |
| 4N     | 114    | 4          | 1215            | First   | 0.414020%                            |
| 4N     | 115    | 4          | 1297            | First   | 0.351917%                            |
| 4N     | 116    | 4          | 1268            | First   | 0.351917%                            |
| 4N     | 117    | 4          | 1268            | First   | 0.414020%                            |
| 4N     | 118    | 3          | 860             | First   | 0.323453%                            |
| 4N     | 119    | 4          | 1080            | First   | 0.351917%                            |
| 4N     | 120    | 4          | 1294            | First   | 0.351917%                            |
| 4N     | 121    | 4          | 1073            | First   | 0.414020%                            |
| 4N     | 122    | 4          | 1297            | First   | 0.414020%                            |

| Bldg # | Unit # | # of Rooms | Approx. Sq. Ft. | Location/ Floor(s) | Proportionate Interest (%) for Units |
|--------|--------|------------|-----------------|--------------------|--------------------------------------|
| 4N     | 123    | 4          | 1057            | First              | 0.351917%                            |
| 4N     | 124    | 4          | 1149            | First              | 0.414020%                            |
| 4N     | 125    | 4          | 1149            | First              | 0.414020%                            |
| 4E     | 201    | 4          | 1108            | Second             | 0.414020%                            |
| 4E     | 202    | 4          | 1113            | Second             | 0.414020%                            |
| 4E     | 203    | 4          | 1020            | Second             | 0.414020%                            |
| 4E     | 204    | 4          | 1253            | Second             | 0.414020%                            |
| 4E     | 205    | 4          | 1035            | Second             | 0.351917%                            |
| 4E     | 206    | 4          | 1255            | Second             | 0.351917%                            |
| 4E     | 207    | 4          | 1035            | Second             | 0.414020%                            |
| 4E     | 208    | 4          | 1271            | Second             | 0.414020%                            |
| 4E     | 209    | 4          | 1255            | Second             | 0.351917%                            |
| 4E     | 210    | 4          | 1256            | Second             | 0.414020%                            |
| 4E     | 211    | 4          | 1255            | Second             | 0.414020%                            |
| 4E     | 212    | 3          | 738             | Second             | 0.322159%                            |
| 4N     | 213    | 4          | 1304            | Second             | 0.414020%                            |
| 4N     | 214    | 2          | 1369            | Second             | 0.323453%                            |
| 4N     | 215    | 4          | 1179            | Second             | 0.414020%                            |
| 4N     | 216    | 4          | 1261            | Second             | 0.351917%                            |
| 4N     | 217    | 4          | 1230            | Second             | 0.414020%                            |
| 4N     | 218    | 4          | 1227            | Second             | 0.351917%                            |
| 4N     | 219    | 4          | 1033            | Second             | 0.351917%                            |
| 4N     | 220    | 4          | 1269            | Second             | 0.414020%                            |
| 4N     | 221    | 4          | 1033            | Second             | 0.414020%                            |
| 4N     | 222    | 4          | 1255            | Second             | 0.351917%                            |
| 4N     | 223    | 4          | 1036            | Second             | 0.414020%                            |
| 4N     | 224    | 4          | 1255            | Second             | 0.414020%                            |
| 4N     | 225    | 4          | 1112            | Second             | 0.414020%                            |
| 4N     | 226    | 4          | 1111            | Second             | 0.414020%                            |
| 4E     | 301    | 4          | 1110            | Third              | 0.414020%                            |
| 4E     | 302    | 4          | 1110            | Third              | 0.414020%                            |
| 4E     | 303    | 4          | 1020            | Third              | 0.351917%                            |
| 4E     | 304    | 4          | 1259            | Third              | 0.414020%                            |
| 4E     | 305    | 4          | 1035            | Third              | 0.414020%                            |
| 4E     | 306    | 4          | 1259            | Third              | 0.414020%                            |
| 4E     | 307    | 4          | 1043            | Third              | 0.351917%                            |
| 4E     | 308    | 4          | 1271            | Third              | 0.414020%                            |
| 4E     | 309    | 4          | 1255            | Third              | 0.414020%                            |
| 4E     | 310    | 4          | 1256            | Third              | 0.351917%                            |
| 4E     | 311    | 4          | 1254            | Third              | 0.414020%                            |
| 4E     | 312    | 3          | 741             | Third              | 0.323453%                            |

| Bldg # | Unit # | # of Rooms | Approx. Sq. Ft. | Location/ Floor(s) | Proportionate Interest (%) for Units |
|--------|--------|------------|-----------------|--------------------|--------------------------------------|
| 4N     | 313    | 4          | 1304            | Third              | 0.414020%                            |
| 4N     | 314    | 2          | 1369            | Third              | 0.323453%                            |
| 4N     | 315    | 4          | 1179            | Third              | 0.414020%                            |
| 4N     | 316    | 4          | 1264            | Third              | 0.351917%                            |
| 4N     | 317    | 4          | 1230            | Third              | 0.414020%                            |
| 4N     | 318    | 4          | 1225            | Third              | 0.414020%                            |
| 4N     | 319    | 4          | 1034            | Third              | 0.351917%                            |
| 4N     | 320    | 4          | 1269            | Third              | 0.414020%                            |
| 4N     | 321    | 4          | 1034            | Third              | 0.414020%                            |
| 4N     | 322    | 4          | 1260            | Third              | 0.414020%                            |
| 4N     | 323    | 4          | 1037            | Third              | 0.351917%                            |
| 4N     | 324    | 4          | 1258            | Third              | 0.414020%                            |
| 4N     | 325    | 4          | 1112            | Third              | 0.414020%                            |
| 4N     | 326    | 4          | 1112            | Third              | 0.414020%                            |
| 1      | 101    | 4          | 1154            | First              | 0.351917%                            |
| 1      | 102    | 4          | 1156            | First              | 0.414020%                            |
| 1      | 103    | 3          | 855             | First              | 0.323453%                            |
| 1      | 104    | 3          | 852             | First              | 0.322159%                            |
| 1      | 105    | 3          | 852             | First              | 0.322159%                            |
| 1      | 106    | 4          | 1074            | First              | 0.414020%                            |
| 1      | 107    | 3          | 849             | First              | 0.323453%                            |
| 1      | 108    | 4          | 1079            | First              | 0.414020%                            |
| 1      | 109    | 3          | 851             | First              | 0.322159%                            |
| 1      | 110    | 3          | 852             | First              | 0.322159%                            |
| 1      | 111    | 3          | 857             | First              | 0.323453%                            |
| 1      | 112    | 4          | 1155            | First              | 0.414020%                            |
| 1      | 113    | 4          | 1154            | First              | 0.414020%                            |
| 1      | 201    | 4          | 1115            | Second             | 0.414020%                            |
| 1      | 202    | 4          | 1115            | Second             | 0.414020%                            |
| 1      | 203    | 4          | 1035            | Second             | 0.351917%                            |
| 1      | 204    | 4          | 1271            | Second             | 0.414020%                            |
| 1      | 205    | 3          | 812             | Second             | 0.323453%                            |
| 1      | 206    | 4          | 1035            | Second             | 0.414020%                            |
| 1      | 207    | 3          | 850             | Second             | 0.322159%                            |
| 1      | 208    | 4          | 1034            | Second             | 0.414020%                            |
| 1      | 209    | 3          | 813             | Second             | 0.323453%                            |
| 1      | 210    | 4          | 1261            | Second             | 0.414020%                            |
| 1      | 211    | 4          | 1032            | Second             | 0.351917%                            |
| 1      | 212    | 4          | 1121            | Second             | 0.414020%                            |
| 1      | 213    | 4          | 1118            | Second             | 0.414020%                            |
| 1      | 301    | 4          | 1120            | Third              | 0.414020%                            |
| 1      | 302    | 4          | 1118            | Third              | 0.414020%                            |

| Bldg # | Unit # | # of Rooms | Approx. Sq. Ft. | Location/ Floor(s)                                  | Proportionate Interest (%) for Units |
|--------|--------|------------|-----------------|---|--------------------------------------|
| 1      | 303    | 4          | 1037            | Third   | 0.351917%                            |
| 1      | 304    | 4          | 1263            | Third   | 0.414020%                            |
| 1      | 305    | 4          | 1250            | Third   | 0.414020%                            |
| 1      | 306    | 4          | 1034            | Third   | 0.414020%                            |
| 1      | 307    | 4          | 1253            | Third   | 0.351917%                            |
| 1      | 308    | 4          | 1038            | Third   | 0.414020%                            |
| 1      | 309    | 4          | 1033            | Third   | 0.414020%                            |
| 1      | 310    | 4          | 1264            | Third   | 0.414020%                            |
| 1      | 311    | 4          | 1117            | Third   | 0.351917%                            |
| 1      | 312    | 4          | 1121            | Third   | 0.414020%                            |
| 16     | 1601   | 4          | 1998            | 1 <sup>st</sup> , 2 <sup>nd</sup>                   | 0.543401%                            |
| 16     | 1602   | 5          | 2109            | 1 <sup>st</sup> , 2 <sup>nd</sup> , 3 <sup>rd</sup> | 0.543401%                            |
| 16     | 1603   | 5          | 2366            | 1 <sup>st</sup> , 2 <sup>nd</sup> , 3 <sup>rd</sup> | 0.543401%                            |
| 16     | 1604   | 5          | 2111            | 1 <sup>st</sup> , 2 <sup>nd</sup> , 3 <sup>rd</sup> | 0.384262%                            |
| 16     | 1605   | 5          | 2114            | 1 <sup>st</sup> , 2 <sup>nd</sup> , 3 <sup>rd</sup> | 0.543401%                            |
| 16     | 1606   | 6          | 2180            | 1 <sup>st</sup> , 2 <sup>nd</sup>                   | 0.543401%                            |
| 17     | 1701   | 7          | 2764            | 1 <sup>st</sup> , 2 <sup>nd</sup> , 3 <sup>rd</sup> | 0.543401%                            |
| 17     | 1702   | 6          | 2264            | 1 <sup>st</sup> , 2 <sup>nd</sup> , 3 <sup>rd</sup> | 0.384262%                            |
| 17     | 1703   | 6          | 2283            | 1 <sup>st</sup> , 2 <sup>nd</sup> , 3 <sup>rd</sup> | 0.543401%                            |
| 18     | 1801   | 7          | 3026            | 1 <sup>st</sup> , 2 <sup>nd</sup> , 3 <sup>rd</sup> | 0.543401%                            |
| 18     | 1802   | 5          | 2083            | 1 <sup>st</sup> , 2 <sup>nd</sup> , 3 <sup>rd</sup> | 0.543401%                            |
| 18     | 1803   | 5          | 1906            | 1 <sup>st</sup> , 2 <sup>nd</sup> , 3 <sup>rd</sup> | 0.543401%                            |
| 18     | 1804   | 5          | 2273            | 1 <sup>st</sup> , 2 <sup>nd</sup> , 3 <sup>rd</sup> | 0.543401%                            |
| 18     | 1805   | 5          | 2083            | 1 <sup>st</sup> , 2 <sup>nd</sup> , 3 <sup>rd</sup> | 0.543401%                            |
| 18     | 1806   | 7          | 3030            | 1 <sup>st</sup> , 2 <sup>nd</sup> , 3 <sup>rd</sup> | 0.543401%                            |
|        |        |            |                 |   | <b>100.000000%</b>                   |

Immediate common areas to which each Unit has access are the common hallways or Building exterior, as shown on the Floor Plans.

**THIRTEENTH AMENDMENT TO MASTER DEED OF  
OAKRIDGE VILLAGE - MAPLEWOOD RESERVE**

**ADDITION OF PHASE 13  
(BUILDING 20)**

VRD ACQUISITION, LLC, a Massachusetts limited liability company with a place of business at 100 Andover By-Pass, North Andover, Massachusetts 01845 being the successor Declarant by deed dated September 1, 2009 and recorded at Book 11757, Page 4 under a Master Deed dated March 14, 2006 and recorded with Essex North District Registry of Deeds (the "Registry") at Book 10082, Page 1, as amended by First Amendment to Master Deed dated April 13, 2006 and recorded with the Registry at Book 10128, Page 127 (the "First Amendment"), Second Amendment to Master Deed dated April 19, 2006 and recorded with the Registry at Book 10140, Page 147, Third Amendment to Master Deed dated June 30, 2006 and recorded with the Registry at Book 10285, Page 169, Fourth Amendment to Master Deed dated August 16, 2006 and recorded with the Registry at Book 10356, Page 32, Fifth Amendment to Master Deed dated October 10, 2006 and recorded with the Registry at Book 10443, Page 137 and Sixth Amendment to Master Deed dated October 23, 2006 and recorded with the Registry at Book 10468, Page 39 and Seventh Amendment to Master Deed dated March 14, 2007 and recorded with the Registry in Book 10667, Page 281 and Eight Amendment to Master Deed dated October 19, 2007 and recorded with the Registry at Book 10947, Page 268 and Ninth Amendment to Master Deed dated July 9, 2010 and recorded with the Registry at Book 12103, Page 214 and Tenth Amendment to Master Deed dated November 12, 2010 and recorded with the Registry at Book 12279, Page 147 and Eleventh Amendment to Master Deed dated April 29, 2011 and recorded with the Registry at Book 12475, Page 170 and Twelfth Amendment to Master Deed dated June 17, 2011 and recorded with the Registry at Book 12522, Page 314 (the "Master Deed"), pursuant to the rights reserved in paragraphs 14 and 18 of the Master Deed to amend the Master Deed, including the right to add additional phases, does hereby amend the Master Deed as contained herein, including the addition of Phase Thirteen (Building 20) to the Condominium. Capitalized terms used but not defined in this Amendment shall have the same definitions given to them in the Master Deed.

1. Phase 13 consists of Building 20 containing three (3) townhouse units;
2. The Master Deed is hereby amended as follows:
  - (a) Paragraph 5 of the Master Deed is hereby amended by deleting the existing Condominium Site Plan(s) and substituting it with a certain plans entitled "Condominium Site Plan - Phase XIII, Oakridge Village / Maplewood Reserve, North Andover, Mass. Drawn for VRD Acquisition, LLC", dated: July 27, 2011, by Merrimack Engineering Services and recorded with the Registry as Plan Nos. 16524 - 16525
  - (b) The Units for Phase 13 (Building 20) are shown on the plans entitled "Project: Maplewood Reserve Building 20, 2001-2003 Dogwood Circle, North Andover, MA 01845." dated, July 18, 2011, containing Sheets 1 through 3, prepared by Vorbach Architecture in accordance with Section 8(f) of the Act and recorded with the Registry as Plan Nos. 16524-16526 and the Floor Plans described in Paragraph 6(a) of the Master Deed, are hereby amended to include the above-described plans.

11  
See Dogwood Circle  
North Andover, MA 01845 -

- (c) Exhibit B to the Master Deed is hereby amended by deleting the existing Exhibit B and substituting it with the Exhibit B attached hereto and made a part hereof.
  - (d) Exhibit C to the Master Deed is hereby amended by deleting the existing Exhibit C and substituting it with the Exhibit C attached hereto and made a part hereof.
3. Giving effect to the foregoing, Phase 13 (Building 20) is hereby added to the Condominium.
  4. Except as hereby amended, the Master Deed is ratified and confirmed in all respects.

IN WITNESS WHEREOF, the said VRD Acquisition, LLC has caused these presents to be executed this 4<sup>th</sup> day of August, 2011.

VRD Acquisition, LLC

By: 

Name: Anthony Mesiti  
Manager

**EXHIBIT B****DESCRIPTION OF BUILDINGS**

There are Eighteen (18) Buildings on the Land described in Exhibit A to this Master Deed contained in phases 1, 2, 3, 4, 5, 6, 7, 8, 9, 10, 11, 12 and 13 of the Condominium. Said Buildings are described as follows:

1. A one (1) story community building containing an indoor swimming pool, shown on the Condominium Site Plan as "1 Story Community Building #5, #5 Harvest Drive".
2. A three (3) story building consisting of thirty eight (38) residential Units shown on the Condominium Site Plan as "3 Story 38 Unit Building #2, #2 Harvest Drive." Said building contains Unit 101 through 312.
3. A two and one-half (2 1/2) story building consisting of twelve (12) residential Townhouse Units and one (1) Garage shown on the Condominium Site Plan as "2 1/2 Story 12 Unit Building #6 601-612 Alder Way." Said building contains Units 601-612.
4. A one (1) story building consisting of five (5) Garages shown on the Condominium Site Plan as "1 Story 5 Car Garage Building #7".
5. A one (1) story building consisting of six (6) Garages shown on the Condominium Site Plan as "1 Story 6 Car Garage Building #8".
6. A three (3) story building consisting of thirty eight (38) residential Units and forty (40) Indoor Parking Spaces, shown on the Condominium Site Plan as "3 Story 38 Unit Building #3, #3 Harvest Drive". Said building contains Units 101 through 312.
7. A two and one-half (2 1/2) story building consisting of six (6) residential Townhouse Units and one (1) Garage shown on the Condominium Site Plan as "2 1/2 Story 6 Unit Building #9 901-906 Alder Way". Said building contains Unit 901 through 906.
8. A one (1) story building consisting of nine (9) Garages shown on the Condominium site Plan as "1 Story 9 Car Garage Building #10".
9. A two and one-half (2 1/2) story building consisting of six (6) residential Townhouse Units shown on the Condominium Site Plan as "2 1/2 Story 6 Unit Building #11 1101-1106 Acorn Drive". Said building contains Unit 1101 through 1106.
10. A one (1) story building consisting of six (6) Garages shown on the Condominium Site Plan as "1 Story 6 Car Garage Building #12".
11. A two and one-half (2 1/2) story building consisting of six (6) residential Townhouse Units and three (3) Garages shown on the Condominium Site Plan as "2 1/2 Story 6 Unit Building #13 1301-1306 Basswood Circle". Said building contains Unit 1301 through 1306.
12. A two and one-half (2 1/2) story building consisting of five (5) residential Townhouse Units and four (4) Garages shown on the Condominium Site Plan as "2 1/2 Story 6 Unit Building #14 1401-1405 Basswood Circle". Said building contains Units 1401 through 1405.
13. A two and one-half (2 1/2) story building consisting of three (3) residential Townhouse Units and three (3) Garages shown on the Condominium Site Plan as "2 1/2 Story 6 Unit Building #15 1501-1503 Basswood Circle". Said building contains Units 1501 through 1503.
14. A three (3) story building consisting of two sections (4N and 4E) containing a total of seventy seven (77) residential Units and eighty four (84) Indoor Parking Spaces. 4N is shown on the Condominium Site Plan as "3 Story 36 Unit Building #4N, #4 Harvest Drive" and 4E is shown on the Condominium Site Plan as "3 Story 36 Unit Building

#4E, #4 Harvest Drive". Said Building 4E contains Units 101 through 112, 201 through 212, and Units 301 through 312 and building 4N contains Units 113 through 125, 213 through 226 and 313 through 326.

15. A three (3) story building consisting of thirty (38) residential Units, shown on the Condominium Site Plan as "3 Story 38 Unit Building #1, #1 Harvest Drive". Said building contains Units 101 through 312.
16. A two and one-half (2 ½) story building consisting of six (6) residential Units and five (5) Garages shown on the Condominium Site Plan as "2 ½ Story Building #16".
17. A two and one-half (2 ½) story building consisting of three (3) residential Units shown on the Condominium Site Plan as "2 ½ Story Building #17".
18. A one story building consisting of six (6) garages spaces shown on the Condominium Site Plan as "1 Story six car Garage Building #19".
19. A two (2) story building consisting of six (6) residential units, shown on the Condominium Site Plan as "2 Story W.F. Building #18".
20. A two and one half (2 ½ ) story building consisting of three (3) residential units, shown on the Condominium Site Plan as "2 ½ Story W.F. Building #20".

**EXHIBIT C**  
**DESCRIPTION OF UNITS**

| Bldg # <sup>1</sup> | Unit # | # of Rooms <sup>2</sup> | Approx. Sq. Ft. <sup>3</sup> | Location/<br>Floor(s) | Proportionate Interest (%) for Units |
|---------------------|--------|-------------------------|------------------------------|-----------------------|--------------------------------------|
| 2                   | 101    | 4                       | 1154                         | First                 | 0.408018%                            |
| 2                   | 102    | 4                       | 1159                         | First                 | 0.408018%                            |
| 2                   | 103    | 3                       | 860                          | First                 | 0.318764%                            |
| 2                   | 104    | 3                       | 852                          | First                 | 0.317489%                            |
| 2                   | 105    | 3                       | 856                          | First                 | 0.317489%                            |
| 2                   | 106    | 4                       | 1077                         | First                 | 0.408018%                            |
| 2                   | 107    | 3                       | 852                          | First                 | 0.318764%                            |
| 2                   | 108    | 4                       | 1077                         | First                 | 0.408018%                            |
| 2                   | 109    | 3                       | 855                          | First                 | 0.317489%                            |
| 2                   | 110    | 3                       | 852                          | First                 | 0.317489%                            |
| 2                   | 111    | 3                       | 859                          | First                 | 0.318764%                            |
| 2                   | 112    | 4                       | 1159                         | First                 | 0.408018%                            |
| 2                   | 113    | 4                       | 1152                         | First                 | 0.408018%                            |
| 2                   | 201    | 4                       | 1116                         | Second                | 0.408018%                            |
| 2                   | 202    | 4                       | 1117                         | Second                | 0.408018%                            |
| 2                   | 203    | 4                       | 1039                         | Second                | 0.346815%                            |
| 2                   | 204    | 4                       | 1259                         | Second                | 0.408018%                            |
| 2                   | 205    | 3                       | 814                          | Second                | 0.318764%                            |
| 2                   | 206    | 4                       | 1035                         | Second                | 0.346815%                            |

<sup>1</sup> As shown on the Condominium Site Plan. The post office address for : (i) Building 1 is 1 Harvest Drive, North Andover, MA 01845; (ii) Building 2 is 2 Harvest Drive, North Andover, MA 01845; (iii) Building 6 is 601-612 Alder Way, North Andover, MA 01845; (iv) Building 3 is 3 Harvest Drive, North Andover, MA 01845; (v) Building 9 is 901-906 Alder Way, North Andover, MA 01845; (vi) Building 11 is 1101-1106 Acorn Drive, North Andover, MA 01845; (vii) Building 13 is 1301-1306 Basswood Circle, North Andover, MA 01845; (viii) Building 14 is 1401-1405 Basswood Circle, North Andover, MA 01845; (ix) Building 15 is 1501-1503 Basswood Circle, North Andover, MA 01845; (x) Building 4N and 4E are 4 Harvest Drive, North Andover, MA 01845; (xi) Building 1 is 1 Harvest Drive, North Andover, MA 01845; (xii) Building 16 is 1601-1606 Catalpa Drive, North Andover, MA 01845 (xiii) Building 17 is 1701-1703 Dogwood Circle, North Andover, MA 01845 (xiv) Building 18 is 1801-1806 Dogwood Circle, North Andover, MA 01845; (xv) Building 20 is 2001-2003 Dogwood Circle, North Andover, MA 01845

<sup>2</sup> Closets, Mechanical Closets, Mechanical rooms, Bathrooms, Balconies and Decks are not included in the number of rooms in the column headed # of Rooms.

<sup>3</sup> The approximate area of the Unit in square feet set forth does not include any balcony or deck.

| Bldg # | Unit # | # of Rooms | Approx. Sq. Ft. | Location/ Floor(s)                                  | Proportionate Interest (%) for Units |
|--------|--------|------------|-----------------|---|--------------------------------------|
| 2      | 207    | 3          | 857             | Second  | 0.317489%                            |
| 2      | 208    | 4          | 1036            | Second  | 0.408018%                            |
| 2      | 209    | 3          | 813             | Second  | 0.318764%                            |
| 2      | 210    | 4          | 1261            | Second  | 0.408018%                            |
| 2      | 211    | 4          | 1032            | Second  | 0.346815%                            |
| 2      | 212    | 4          | 1117            | Second  | 0.408018%                            |
| 2      | 213    | 4          | 1118            | Second  | 0.408018%                            |
| 2      | 301    | 4          | 1121            | Thrd  | 0.408018%                            |
| 2      | 302    | 4          | 1118            | Third   | 0.408018%                            |
| 2      | 303    | 4          | 1043            | Third   | 0.346815%                            |
| 2      | 304    | 4          | 1267            | Third   | 0.408018%                            |
| 2      | 305    | 4          | 1257            | Third   | 0.408018%                            |
| 2      | 306    | 4          | 1031            | Third   | 0.346815%                            |
| 2      | 307    | 4          | 1257            | Third   | 0.408018%                            |
| 2      | 308    | 4          | 1038            | Third   | 0.408018%                            |
| 2      | 309    | 4          | 1035            | Third   | 0.408018%                            |
| 2      | 310    | 4          | 1264            | Third   | 0.408018%                            |
| 2      | 311    | 4          | 1117            | Third   | 0.346815%                            |
| 2      | 312    | 4          | 1121            | Third   | 0.408018%                            |
| 6      | 601    | 6          | 1912            | 1 <sup>st</sup> , 2 <sup>nd</sup> , 3 <sup>rd</sup> | 0.535523%                            |
| 6      | 602    | 5          | 1911            | 1 <sup>st</sup> , 2 <sup>nd</sup> , 3 <sup>rd</sup> | 0.535523%                            |
| 6      | 603    | 5          | 1904            | 1 <sup>st</sup> , 2 <sup>nd</sup> , 3 <sup>rd</sup> | 0.535523%                            |
| 6      | 604    | 6          | 1919            | 1 <sup>st</sup> , 2 <sup>nd</sup> , 3 <sup>rd</sup> | 0.535523%                            |
| 6      | 605    | 6          | 2044            | 1 <sup>st</sup> , 2 <sup>nd</sup> , 3 <sup>rd</sup> | 0.535523%                            |
| 6      | 606    | 6          | 1916            | 1 <sup>st</sup> , 2 <sup>nd</sup> , 3 <sup>rd</sup> | 0.535523%                            |
| 6      | 607    | 5          | 1909            | 1 <sup>st</sup> , 2 <sup>nd</sup> , 3 <sup>rd</sup> | 0.535523%                            |
| 6      | 608    | 5          | 1911            | 1 <sup>st</sup> , 2 <sup>nd</sup> , 3 <sup>rd</sup> | 0.378691%                            |
| 6      | 609    | 5          | 1905            | 1 <sup>st</sup> , 2 <sup>nd</sup> , 3 <sup>rd</sup> | 0.535523%                            |
| 6      | 610    | 5          | 1911            | 1 <sup>st</sup> , 2 <sup>nd</sup> , 3 <sup>rd</sup> | 0.378691%                            |
| 6      | 611    | 6          | 1908            | 1 <sup>st</sup> , 2 <sup>nd</sup> , 3 <sup>rd</sup> | 0.535523%                            |
| 6      | 612    | 7          | 1905            | 1 <sup>st</sup> , 2 <sup>nd</sup>                   | 0.535523%                            |
| 3      | 101    | 4          | 1149            | First   | 0.408018%                            |
| 3      | 102    | 4          | 1155            | First   | 0.408018%                            |
| 3      | 103    | 4          | 1054            | First   | 0.408018%                            |
| 3      | 104    | 3          | 859             | First   | 0.317489%                            |
| 3      | 105    | 3          | 850             | First   | 0.317489%                            |
| 3      | 106    | 4          | 1080            | First   | 0.408018%                            |
| 3      | 107    | 3          | 847             | First   | 0.318764%                            |
| 3      | 108    | 4          | 1079            | First   | 0.408018%                            |
| 3      | 109    | 3          | 854             | First   | 0.317489%                            |
| 3      | 110    | 3          | 858             | First   | 0.317489%                            |

| Bldg # | Unit # | # of Rooms | Approx. Sq. Ft. | Location/ Floor(s)                                  | Proportionate Interest (%) for Units |
|--------|--------|------------|-----------------|---|--------------------------------------|
| 3      | 111    | 4          | 1051            | First   | 0.408018%                            |
| 3      | 112    | 4          | 1150            | First   | 0.408018%                            |
| 3      | 113    | 4          | 1152            | First   | 0.408018%                            |
| 3      | 201    | 4          | 1116            | Second  | 0.408018%                            |
| 3      | 202    | 4          | 1114            | Second  | 0.408018%                            |
| 3      | 203    | 4          | 1029            | Second  | 0.346815%                            |
| 3      | 204    | 4          | 1264            | Second  | 0.408018%                            |
| 3      | 205    | 3          | 809             | Second  | 0.318764%                            |
| 3      | 206    | 4          | 1034            | Second  | 0.346815%                            |
| 3      | 207    | 3          | 848             | Second  | 0.317489%                            |
| 3      | 208    | 4          | 1035            | Second  | 0.408018%                            |
| 3      | 209    | 3          | 806             | Second  | 0.318764%                            |
| 3      | 210    | 4          | 1264            | Second  | 0.408018%                            |
| 3      | 211    | 4          | 1026            | Second  | 0.346815%                            |
| 3      | 212    | 4          | 1115            | Second  | 0.408018%                            |
| 3      | 213    | 4          | 1111            | Second  | 0.408018%                            |
| 3      | 301    | 4          | 1112            | Third   | 0.408018%                            |
| 3      | 302    | 4          | 1114            | Third   | 0.408018%                            |
| 3      | 303    | 4          | 1030            | Third   | 0.346815%                            |
| 3      | 304    | 4          | 1267            | Third   | 0.408018%                            |
| 3      | 305    | 4          | 1243            | Third   | 0.408018%                            |
| 3      | 306    | 4          | 1058            | Third   | 0.346815%                            |
| 3      | 307    | 4          | 1243            | Third   | 0.408018%                            |
| 3      | 308    | 4          | 1042            | Third   | 0.408018%                            |
| 3      | 309    | 4          | 1028            | Third   | 0.408018%                            |
| 3      | 310    | 4          | 1270            | Third   | 0.408018%                            |
| 3      | 311    | 4          | 1107            | Third   | 0.408018%                            |
| 3      | 312    | 4          | 1120            | Third   | 0.408018%                            |
| 9      | 901    | 6          | 1896            | 1 <sup>st</sup> , 2 <sup>nd</sup> , 3 <sup>rd</sup> | 0.535523%                            |
| 9      | 902    | 5          | 1918            | 1 <sup>st</sup> , 2 <sup>nd</sup> , 3 <sup>rd</sup> | 0.378691%                            |
| 9      | 903    | 6          | 1912            | 1 <sup>st</sup> , 2 <sup>nd</sup> , 3 <sup>rd</sup> | 0.535523%                            |
| 9      | 904    | 6          | 1912            | 1 <sup>st</sup> , 2 <sup>nd</sup> , 3 <sup>rd</sup> | 0.535523%                            |
| 9      | 905    | 5          | 1916            | 1 <sup>st</sup> , 2 <sup>nd</sup> , 3 <sup>rd</sup> | 0.378691%                            |
| 9      | 906    | 7          | 1905            | 1 <sup>st</sup> , 2 <sup>nd</sup> , 3 <sup>rd</sup> | 0.535523%                            |
| 11     | 1101   | 6          | 1636            | 1 <sup>st</sup> , 2 <sup>nd</sup>                   | 0.535523%                            |
| 11     | 1102   | 5          | 1917            | 1 <sup>st</sup> , 2 <sup>nd</sup> , 3 <sup>rd</sup> | 0.535523%                            |
| 11     | 1103   | 6          | 2106            | 1 <sup>st</sup> , 2 <sup>nd</sup> , 3 <sup>rd</sup> | 0.378691%                            |
| 11     | 1104   | 5          | 1715            | 1 <sup>st</sup> , 2 <sup>nd</sup> , 3 <sup>rd</sup> | 0.535523%                            |
| 11     | 1105   | 5          | 1911            | 1 <sup>st</sup> , 2 <sup>nd</sup> , 3 <sup>rd</sup> | 0.535523%                            |
| 11     | 1106   | 6          | 1646            | 1 <sup>st</sup> , 2 <sup>nd</sup>                   | 0.535523%                            |

| Bldg # | Unit # | # of Rooms | Approx. Sq. Ft. | Location/ Floor(s)                                  | Proportionate Interest (%) for Units |
|--------|--------|------------|-----------------|---|--------------------------------------|
| 13     | 1301   | 6          | 1909            | 1 <sup>st</sup> , 2 <sup>nd</sup> , 3 <sup>rd</sup> | 0.535523%                            |
| 13     | 1302   | 5          | 1915            | 1 <sup>st</sup> , 2 <sup>nd</sup> , 3 <sup>rd</sup> | 0.378691%                            |
| 13     | 1303   | 5          | 1917            | 1 <sup>st</sup> , 2 <sup>nd</sup> , 3 <sup>rd</sup> | 0.535523%                            |
| 13     | 1304   | 5          | 1720            | 1 <sup>st</sup> , 2 <sup>nd</sup> , 3 <sup>rd</sup> | 0.378691%                            |
| 13     | 1305   | 6          | 2110            | 1 <sup>st</sup> , 2 <sup>nd</sup> , 3 <sup>rd</sup> | 0.378691%                            |
| 13     | 1306   | 7          | 1936            | 1 <sup>st</sup> , 2 <sup>nd</sup>                   | 0.535523%                            |
| 14     | 1401   | 6          | 2099            | 1 <sup>st</sup> , 2 <sup>nd</sup> , 3 <sup>rd</sup> | 0.378691%                            |
| 14     | 1402   | 5          | 1712            | 1 <sup>st</sup> , 2 <sup>nd</sup> , 3 <sup>rd</sup> | 0.378691%                            |
| 14     | 1403   | 5          | 1907            | 1 <sup>st</sup> , 2 <sup>nd</sup> , 3 <sup>rd</sup> | 0.535523%                            |
| 14     | 1404   | 5          | 1910            | 1 <sup>st</sup> , 2 <sup>nd</sup> , 3 <sup>rd</sup> | 0.378691%                            |
| 14     | 1405   | 6          | 1897            | 1 <sup>st</sup> , 2 <sup>nd</sup> , 3 <sup>rd</sup> | 0.378691%                            |
| 15     | 1501   | 6          | 1896            | 1 <sup>st</sup> , 2 <sup>nd</sup> , 3 <sup>rd</sup> | 0.535523%                            |
| 15     | 1502   | 5          | 1909            | 1 <sup>st</sup> , 2 <sup>nd</sup> , 3 <sup>rd</sup> | 0.378691%                            |
| 15     | 1503   | 5          | 1566            | 1st, 2nd  | 0.535523%                            |
| 4E     | 101    | 4          | 1146            | First   | 0.408018%                            |
| 4E     | 102    | 4          | 1151            | First   | 0.408018%                            |
| 4E     | 103    | 4          | 1058            | First   | 0.346815%                            |
| 4E     | 104    | 4          | 1295            | First   | 0.408018%                            |
| 4E     | 105    | 4          | 1073            | First   | 0.408018%                            |
| 4E     | 106    | 4          | 1297            | First   | 0.346815%                            |
| 4E     | 107    | 4          | 1074            | First   | 0.408018%                            |
| 4E     | 108    | 3          | 856             | First   | 0.317489%                            |
| 4E     | 109    | 4          | 1296            | First   | 0.408018%                            |
| 4E     | 110    | 4          | 1293            | First   | 0.408018%                            |
| 4E     | 111    | 4          | 1292            | First   | 0.408018%                            |
| 4E     | 112    | 3          | 816             | First   | 0.317489%                            |
| 4N     | 113    | 4          | 1340            | First   | 0.408018%                            |
| 4N     | 114    | 4          | 1215            | First   | 0.408018%                            |
| 4N     | 115    | 4          | 1297            | First   | 0.346815%                            |
| 4N     | 116    | 4          | 1268            | First   | 0.346815%                            |
| 4N     | 117    | 4          | 1268            | First   | 0.408018%                            |
| 4N     | 118    | 3          | 860             | First   | 0.318764%                            |
| 4N     | 119    | 4          | 1080            | First   | 0.346815%                            |
| 4N     | 120    | 4          | 1294            | First   | 0.346815%                            |
| 4N     | 121    | 4          | 1073            | First   | 0.408018%                            |
| 4N     | 122    | 4          | 1297            | First   | 0.408018%                            |

| Bldg # | Unit # | # of Rooms | Approx. Sq. Ft. | Location/ Floor(s) | Proportionate Interest (%) for Units |
|--------|--------|------------|-----------------|--------------------|--------------------------------------|
| 4N     | 123    | 4          | 1057            | First              | 0.346815%                            |
| 4N     | 124    | 4          | 1149            | First              | 0.408018%                            |
| 4N     | 125    | 4          | 1149            | First              | 0.408018%                            |
| 4E     | 201    | 4          | 1108            | Second             | 0.408018%                            |
| 4E     | 202    | 4          | 1113            | Second             | 0.408018%                            |
| 4E     | 203    | 4          | 1020            | Second             | 0.408018%                            |
| 4E     | 204    | 4          | 1253            | Second             | 0.408018%                            |
| 4E     | 205    | 4          | 1035            | Second             | 0.346815%                            |
| 4E     | 206    | 4          | 1255            | Second             | 0.346815%                            |
| 4E     | 207    | 4          | 1035            | Second             | 0.408018%                            |
| 4E     | 208    | 4          | 1271            | Second             | 0.408018%                            |
| 4E     | 209    | 4          | 1255            | Second             | 0.346815%                            |
| 4E     | 210    | 4          | 1256            | Second             | 0.408018%                            |
| 4E     | 211    | 4          | 1255            | Second             | 0.408018%                            |
| 4E     | 212    | 3          | 738             | Second             | 0.317489%                            |
| 4N     | 213    | 4          | 1304            | Second             | 0.408018%                            |
| 4N     | 214    | 2          | 1369            | Second             | 0.318764%                            |
| 4N     | 215    | 4          | 1179            | Second             | 0.408018%                            |
| 4N     | 216    | 4          | 1261            | Second             | 0.346815%                            |
| 4N     | 217    | 4          | 1230            | Second             | 0.408018%                            |
| 4N     | 218    | 4          | 1227            | Second             | 0.346815%                            |
| 4N     | 219    | 4          | 1033            | Second             | 0.346815%                            |
| 4N     | 220    | 4          | 1269            | Second             | 0.408018%                            |
| 4N     | 221    | 4          | 1033            | Second             | 0.408018%                            |
| 4N     | 222    | 4          | 1255            | Second             | 0.346815%                            |
| 4N     | 223    | 4          | 1036            | Second             | 0.408018%                            |
| 4N     | 224    | 4          | 1255            | Second             | 0.408018%                            |
| 4N     | 225    | 4          | 1112            | Second             | 0.408018%                            |
| 4N     | 226    | 4          | 1111            | Second             | 0.408018%                            |
| 4E     | 301    | 4          | 1110            | Third              | 0.408018%                            |
| 4E     | 302    | 4          | 1110            | Third              | 0.408018%                            |
| 4E     | 303    | 4          | 1020            | Third              | 0.346815%                            |
| 4E     | 304    | 4          | 1259            | Third              | 0.408018%                            |
| 4E     | 305    | 4          | 1035            | Third              | 0.408018%                            |
| 4E     | 306    | 4          | 1259            | Third              | 0.408018%                            |
| 4E     | 307    | 4          | 1043            | Third              | 0.346815%                            |
| 4E     | 308    | 4          | 1271            | Third              | 0.408018%                            |
| 4E     | 309    | 4          | 1255            | Third              | 0.408018%                            |
| 4E     | 310    | 4          | 1256            | Third              | 0.346815%                            |
| 4E     | 311    | 4          | 1254            | Third              | 0.408018%                            |
| 4E     | 312    | 3          | 741             | Third              | 0.318764%                            |

| Bldg # | Unit # | # of Rooms | Approx. Sq. Ft. | Location/ Floor(s) | Proportionate Interest (%) for Units |
|--------|--------|------------|-----------------|--------------------|--------------------------------------|
| 4N     | 313    | 4          | 1304            | Third              | 0.408018%                            |
| 4N     | 314    | 2          | 1369            | Third              | 0.318764%                            |
| 4N     | 315    | 4          | 1179            | Third              | 0.408018%                            |
| 4N     | 316    | 4          | 1264            | Third              | 0.346815%                            |
| 4N     | 317    | 4          | 1230            | Third              | 0.408018%                            |
| 4N     | 318    | 4          | 1225            | Third              | 0.408018%                            |
| 4N     | 319    | 4          | 1034            | Third              | 0.346815%                            |
| 4N     | 320    | 4          | 1269            | Third              | 0.408018%                            |
| 4N     | 321    | 4          | 1034            | Third              | 0.408018%                            |
| 4N     | 322    | 4          | 1260            | Third              | 0.408018%                            |
| 4N     | 323    | 4          | 1037            | Third              | 0.346815%                            |
| 4N     | 324    | 4          | 1258            | Third              | 0.408018%                            |
| 4N     | 325    | 4          | 1112            | Third              | 0.408018%                            |
| 4N     | 326    | 4          | 1112            | Third              | 0.408018%                            |
| 1      | 101    | 4          | 1154            | First              | 0.346815%                            |
| 1      | 102    | 4          | 1156            | First              | 0.408018%                            |
| 1      | 103    | 3          | 855             | First              | 0.318764%                            |
| 1      | 104    | 3          | 852             | First              | 0.317489%                            |
| 1      | 105    | 3          | 852             | First              | 0.317489%                            |
| 1      | 106    | 4          | 1074            | First              | 0.408018%                            |
| 1      | 107    | 3          | 849             | First              | 0.318764%                            |
| 1      | 108    | 4          | 1079            | First              | 0.408018%                            |
| 1      | 109    | 3          | 851             | First              | 0.317489%                            |
| 1      | 110    | 3          | 852             | First              | 0.317489%                            |
| 1      | 111    | 3          | 857             | First              | 0.318764%                            |
| 1      | 112    | 4          | 1155            | First              | 0.408018%                            |
| 1      | 113    | 4          | 1154            | First              | 0.408018%                            |
| 1      | 201    | 4          | 1115            | Second             | 0.408018%                            |
| 1      | 202    | 4          | 1115            | Second             | 0.408018%                            |
| 1      | 203    | 4          | 1035            | Second             | 0.346815%                            |
| 1      | 204    | 4          | 1271            | Second             | 0.408018%                            |
| 1      | 205    | 3          | 812             | Second             | 0.318764%                            |
| 1      | 206    | 4          | 1035            | Second             | 0.408018%                            |
| 1      | 207    | 3          | 850             | Second             | 0.317489%                            |
| 1      | 208    | 4          | 1034            | Second             | 0.408018%                            |
| 1      | 209    | 3          | 813             | Second             | 0.318764%                            |
| 1      | 210    | 4          | 1261            | Second             | 0.408018%                            |
| 1      | 211    | 4          | 1032            | Second             | 0.346815%                            |
| 1      | 212    | 4          | 1121            | Second             | 0.408018%                            |
| 1      | 213    | 4          | 1118            | Second             | 0.408018%                            |
| 1      | 301    | 4          | 1120            | Third              | 0.408018%                            |
| 1      | 302    | 4          | 1118            | Thlrd              | 0.408018%                            |

| Bldg # | Unit # | # of Rooms | Approx. Sq. Ft. | Location/ Floor(s)                                  | Proportionate Interest (%) for Units |
|--------|--------|------------|-----------------|---|--------------------------------------|
| 1      | 303    | 4          | 1037            | Third   | 0.346815%                            |
| 1      | 304    | 4          | 1263            | Third   | 0.408018%                            |
| 1      | 305    | 4          | 1250            | Third   | 0.408018%                            |
| 1      | 306    | 4          | 1034            | Third   | 0.408018%                            |
| 1      | 307    | 4          | 1253            | Third   | 0.346815%                            |
| 1      | 308    | 4          | 1038            | Third   | 0.408018%                            |
| 1      | 309    | 4          | 1033            | Third   | 0.408018%                            |
| 1      | 310    | 4          | 1264            | Third   | 0.408018%                            |
| 1      | 311    | 4          | 1117            | Third   | 0.346815%                            |
| 1      | 312    | 4          | 1121            | Third   | 0.408018%                            |
| 16     | 1601   | 4          | 1998            | 1 <sup>st</sup> , 2 <sup>nd</sup>                   | 0.535523%                            |
| 16     | 1602   | 5          | 2109            | 1 <sup>st</sup> , 2 <sup>nd</sup> , 3 <sup>rd</sup> | 0.535523%                            |
| 16     | 1603   | 5          | 2366            | 1 <sup>st</sup> , 2 <sup>nd</sup> , 3 <sup>rd</sup> | 0.535523%                            |
| 16     | 1604   | 5          | 2111            | 1 <sup>st</sup> , 2 <sup>nd</sup> , 3 <sup>rd</sup> | 0.378691%                            |
| 16     | 1605   | 5          | 2114            | 1 <sup>st</sup> , 2 <sup>nd</sup> , 3 <sup>rd</sup> | 0.535523%                            |
| 16     | 1606   | 6          | 2180            | 1 <sup>st</sup> , 2 <sup>nd</sup>                   | 0.535523%                            |
| 17     | 1701   | 7          | 2764            | 1 <sup>st</sup> , 2 <sup>nd</sup> , 3 <sup>rd</sup> | 0.535523%                            |
| 17     | 1702   | 6          | 2264            | 1 <sup>st</sup> , 2 <sup>nd</sup> , 3 <sup>rd</sup> | 0.378691%                            |
| 17     | 1703   | 6          | 2283            | 1 <sup>st</sup> , 2 <sup>nd</sup> , 3 <sup>rd</sup> | 0.535523%                            |
| 18     | 1801   | 7          | 3026            | 1 <sup>st</sup> , 2 <sup>nd</sup> , 3 <sup>rd</sup> | 0.535523%                            |
| 18     | 1802   | 5          | 2083            | 1 <sup>st</sup> , 2 <sup>nd</sup> , 3 <sup>rd</sup> | 0.535523%                            |
| 18     | 1803   | 5          | 1906            | 1 <sup>st</sup> , 2 <sup>nd</sup> , 3 <sup>rd</sup> | 0.535523%                            |
| 18     | 1804   | 5          | 2273            | 1 <sup>st</sup> , 2 <sup>nd</sup> , 3 <sup>rd</sup> | 0.535523%                            |
| 18     | 1805   | 5          | 2083            | 1 <sup>st</sup> , 2 <sup>nd</sup> , 3 <sup>rd</sup> | 0.535523%                            |
| 18     | 1806   | 7          | 3030            | 1 <sup>st</sup> , 2 <sup>nd</sup> , 3 <sup>rd</sup> | 0.535523%                            |
| 20     | 2001   | 8          | 2160            | 1 <sup>st</sup> , 2 <sup>nd</sup> , 3 <sup>rd</sup> | 0.535523%                            |
| 20     | 2002   | 8          | 2118            | 1 <sup>st</sup> , 2 <sup>nd</sup> , 3 <sup>rd</sup> | 0.378691%                            |
| 20     | 2003   | 7          | 3028            | 1 <sup>st</sup> , 2 <sup>nd</sup> , 3 <sup>rd</sup> | 0.535523%                            |
|        |        |            |                 |   | <b>100.000000%</b>                   |

Immediate common areas to which each Unit has access are the common hallways or Building exterior, as shown on the Floor Plans.

**FOURTEEN AMENDMENT TO MASTER DEED OF  
OAKRIDGE VILLAGE - MAPLEWOOD RESERVE**

**ADDITION OF PHASE 14  
(BUILDING 22)**



VRD ACQUISITION, LLC, a Massachusetts limited liability company with a place of business at 100 Andover By-Pass, North Andover, Massachusetts 01845 being the successor Declarant by deed dated September 1, 2009 and recorded at Book 11757, Page 4 under a Master Deed dated March 14, 2006 and recorded with Essex North District Registry of Deeds (the "Registry") at Book 10082, Page 1, as amended by First Amendment to Master Deed dated April 13, 2006 and recorded with the Registry at Book 10128, Page 127 (the "First Amendment"), Second Amendment to Master Deed dated April 19, 2006 and recorded with the Registry at Book 10140, Page 147, Third Amendment to Master Deed dated June 30, 2006 and recorded with the Registry at Book 10285, Page 169, Fourth Amendment to Master Deed dated August 16, 2006 and recorded with the Registry at Book 10356, Page 32, Fifth Amendment to Master Deed dated October 10, 2006 and recorded with the Registry at Book 10443, Page 137 and Sixth Amendment to Master Deed dated October 23, 2006 and recorded with the Registry at Book 10468, Page 39 and Seventh Amendment to Master Deed dated March 14, 2007 and recorded with the Registry in Book 10667, Page 281 and Eight Amendment to Master Deed dated October 19, 2007 and recorded with the Registry at Book 10947, Page 268 and Ninth Amendment to Master Deed dated July 9, 2010 and recorded with the Registry at Book 12103, Page 214 and Tenth Amendment to Master Deed dated November 12, 2010 and recorded with the Registry at Book 12279, Page 147 and Eleventh Amendment to Master Deed dated April 29, 2011 and recorded with the Registry at Book 12475, Page 170 and Twelfth Amendment to Master Deed dated June 17, 2011 and recorded with the Registry at Book 12522, Page 314 and Thirteen Amendment to Master Deed dated August 4, 2011 and recorded with the Registry at Book 12569, Page 202 (the "Master Deed"), pursuant to the rights reserved in paragraphs 14 and 18 of the Master Deed to amend the Master Deed, including the right to add additional phases, does hereby amend the Master Deed as contained herein, including the addition of Phase Fourteen (Building 22) to the Condominium. Capitalized terms used but not defined in this Amendment shall have the same definitions given to them in the Master Deed.

1. Phase 14 consists of Building 22 containing three (3) townhouse units and two garage spaces;
2. The Master Deed is hereby amended as follows:
  - (a) Paragraph 5 of the Master Deed is hereby amended by deleting the existing Condominium Site Plan(s) and substituting it with a certain plans entitled "Condominium Site Plan - Phase XIV, Oakridge Village / Maplewood Reserve, North Andover, Mass. Drawn for VRD Acquisition, LLC", dated: December 23, 2011, by Merrimack Engineering Services and recorded with the Registry as Plan Nos. \_\_\_\_\_.
  - (b) The Townhouse Units and Garage space for Phase 14 (Building 22) are shown on the plans entitled "Project: Maplewood Reserve Building 22, 2201-2203 Juniper Circle, North Andover, MA 01845." dated, December 21, 2011, containing Sheets 1 through 3, prepared by Vorbach Architecture in accordance with Section 8(f) of the Act and recorded with the Registry as Plan Nos. \_\_\_\_\_ and the Floor Plans described in Paragraph 6(a) of the

Master Deed, are hereby amended to include the above-described plans.

- (c) Exhibit B to the Master Deed is hereby amended by deleting the existing Exhibit B and substituting it with the Exhibit B attached hereto and made a part hereof.
  - (d) Exhibit C to the Master Deed is hereby amended by deleting the existing Exhibit C and substituting it with the Exhibit C attached hereto and made a part hereof.
  - (e) Phase 10 of the Condominium consisted of Building 17 which contains three (3) townhouse units and One (1) garage space. The garage space was inadvertently left off the Tenth phasing amendment adding Building 17 to the Condominium.
  - (f) Phase 12 of the Condominium consisted of Building 18 which contains six (6) townhouse units and two (2) garage spaces. The garage spaces were inadvertently left off the Eleventh phasing amendment adding Building 18 to the Condominium.
  - (g) Phase 13 of the Condominium consisted of Building 20 which contains three (3) townhouse units and One (1) garage space. The garage space was inadvertently left off the Tenth phasing amendment adding Building 20 to the Condominium.
3. Giving effect to the foregoing, Phase 14 (Building 22) is hereby added to the Condominium.
4. Except as hereby amended, the Master Deed is ratified and confirmed in all respects.

IN WITNESS WHEREOF, the said VRD Acquisition, LLC has caused these presents to be executed this 9 day of January, 2012.

VRD Acquisition, LLC

By: 

Name: Anthony Mesiti  
Manager

## EXHIBIT B

### DESCRIPTION OF BUILDINGS

There are Twenty-One (21) Buildings on the Land described in Exhibit A to this Master Deed contained in phases 1, 2, 3, 4, 5, 6, 7, 8, 9, 10, 11, 12, 13 and 14 of the Condominium. Said Buildings are described as follows:

1. A one (1) story community building containing an indoor swimming pool, shown on the Condominium Site Plan as "1 Story Community Building #5, #5 Harvest Drive".
2. A three (3) story building consisting of thirty eight (38) residential Units shown on the Condominium Site Plan as "3 Story 38 Unit Building #2, #2 Harvest Drive." Said building contains Unit 101 through 312.
3. A two and one-half (2 1/2) story building consisting of twelve (12) residential Townhouse Units and one (1) Garage shown on the Condominium Site Plan as "2 1/2 Story 12 Unit Building #6 601-612 Alder Way." Said building contains Units 601-612.
4. A one (1) story building consisting of five (5) Garages shown on the Condominium Site Plan as "1 Story 5 Car Garage Building #7".
5. A one (1) story building consisting of six (6) Garages shown on the Condominium Site Plan as "1 Story 6 Car Garage Building #8".
6. A three (3) story building consisting of thirty eight (38) residential Units and forty (40) Indoor Parking Spaces, shown on the Condominium Site Plan as "3 Story 38 Unit Building #3, #3 Harvest Drive". Said building contains Units 101 through 312.
7. A two and one-half (2 1/2) story building consisting of six (6) residential Townhouse Units and one (1) Garage shown on the Condominium Site Plan as "2 1/2 Story 6 Unit Building #9 901-906 Alder Way". Said building contains Unit 901 through 906.
8. A one (1) story building consisting of nine (9) Garages shown on the Condominium site Plan as "1 Story 9 Car Garage Building #10".
9. A two and one-half (2 1/2) story building consisting of six (6) residential Townhouse Units shown on the Condominium Site Plan as "2 1/2 Story 6 Unit Building #11 1101-1106 Acorn Drive". Said building contains Unit 1101 through 1106.
10. A one (1) story building consisting of six (6) Garages shown on the Condominium Site Plan as "1 Story 6 Car Garage Building #12".
11. A two and one-half (2 1/2) story building consisting of six (6) residential Townhouse Units and three (3) Garages shown on the Condominium Site Plan as "2 1/2 Story 6 Unit Building #13 1301-1306 Basswood Circle". Said building contains Unit 1301 through 1306.
12. A two and one-half (2 1/2) story building consisting of five (5) residential Townhouse Units and four (4) Garages shown on the Condominium Site Plan as "2 1/2 Story 6 Unit Building #14 1401-1405 Basswood Circle". Said building contains Units 1401 through 1405.
13. A two and one-half (2 1/2) story building consisting of three (3) residential Townhouse Units and three (3) Garages shown on the Condominium Site Plan as "2 1/2 Story 6 Unit Building #15 1501-1503 Basswood Circle". Said building contains Units 1501 through 1503.
14. A three (3) story building consisting of two sections (4N and 4E) containing a total of seventy seven (77) residential Units and eighty four (84) Indoor Parking Spaces. 4N is shown on the Condominium Site Plan as "3 Story 36 Unit Building #4N, #4 Harvest Drive" and 4E is shown on the Condominium Site Plan as "3 Story 36 Unit Building

#4E, #4 Harvest Drive". Said Building 4E contains Units 101 through 112, 201 through 212, and Units 301 through 312 and building 4N contains Units 113 through 125, 213 through 226 and 313 through 326.

15. A three (3) story building consisting of thirty (38) residential Units, shown on the Condominium Site Plan as "3 Story 38 Unit Building #1, #1 Harvest Drive". Said building contains Units 101 through 312.
16. A two and one-half (2 ½) story building consisting of six (6) residential Units and five (5) Garages shown on the Condominium Site Plan as "2 ½ Story Building #16".
17. A two and one-half (2 ½) story building consisting of three (3) residential Units and One (1) Garage space as shown on the Condominium Site Plan as "2 ½ Story Building #17".
18. A one story building consisting of six (6) garages spaces shown on the Condominium Site Plan as "1 Story six car Garage Building #19".
19. A two (2) story building consisting of six (6) residential units and Two (2) Garage Spaces, shown on the Condominium Site Plan as "2 Story W.F. Building #18".
20. A two and one half (2 ½ ) story building consisting of three (3) residential units and One (1) Garage space, shown on the Condominium Site Plan as "2 ½ Story W.F. Building #20".
21. A three (3) story building consisting of three (3) residential units and two garage spaces shown on Condominium Site Plan as "3 Story 3 Unit Building #22"

**EXHIBIT C  
DESCRIPTION OF UNITS**

| Bldg # <sup>1</sup> | Unit # | # of Rooms <sup>2</sup> | Approx. Sq. Ft. <sup>3</sup> | Location/<br>Floor(s) | Proportionate Interst (%) for Units |
|---------------------|--------|-------------------------|------------------------------|-----------------------|-------------------------------------|
| 2                   | 101    | 4                       | 1154                         | First                 | 0.402187%                           |
| 2                   | 102    | 4                       | 1159                         | First                 | 0.402187%                           |
| 2                   | 103    | 3                       | 860                          | First                 | 0.314209%                           |
| 2                   | 104    | 3                       | 852                          | First                 | 0.312952%                           |
| 2                   | 105    | 3                       | 856                          | First                 | 0.312952%                           |
| 2                   | 106    | 4                       | 1077                         | First                 | 0.402187%                           |
| 2                   | 107    | 3                       | 852                          | First                 | 0.314209%                           |
| 2                   | 108    | 4                       | 1077                         | First                 | 0.402187%                           |
| 2                   | 109    | 3                       | 855                          | First                 | 0.312952%                           |
| 2                   | 110    | 3                       | 852                          | First                 | 0.312952%                           |
| 2                   | 111    | 3                       | 859                          | First                 | 0.314209%                           |
| 2                   | 112    | 4                       | 1159                         | First                 | 0.402187%                           |
| 2                   | 113    | 4                       | 1152                         | First                 | 0.402187%                           |
| 2                   | 201    | 4                       | 1116                         | Second                | 0.402187%                           |
| 2                   | 202    | 4                       | 1117                         | Second                | 0.402187%                           |
| 2                   | 203    | 4                       | 1039                         | Second                | 0.341859%                           |
| 2                   | 204    | 4                       | 1259                         | Second                | 0.402187%                           |
| 2                   | 205    | 3                       | 814                          | Second                | 0.314209%                           |
| 2                   | 206    | 4                       | 1035                         | Second                | 0.341859%                           |

<sup>1</sup> As shown on the Condominium Site Plan. The post office address for : (i) Building 1 is 1 Harvest Drive, North Andover, MA 01845; (ii) Building 2 is 2 Harvest Drive, North Andover, MA 01845; (iii) Building 6 is 601-612 Alder Way, North Andover, MA 01845; (iv) Building 3 is 3 Harvest Drive, North Andover, MA 01845; (v) Building 9 is 901-906 Alder Way, North Andover, MA 01845; (vi) Building 11 is 1101-1106 Acorn Drive, North Andover, MA 01845; (vii) Building 13 is 1301-1306 Basswood Circle, North Andover, MA 01845; (viii) Building 14 is 1401-1405 Basswood Circle, North Andover, MA 01845; (ix) Building 15 is 1501-1503 Basswood Circle, North Andover, MA 01845; (x) Building 4N and 4E are 4 Harvest Drive, North Andover, MA 01845; (xi) Building 1 is 1 Harvest Drive, North Andover, MA 01845; (xii) Building 16 is 1601-1606 Catalpa Drive, North Andover, MA 01845 (xiii) Building 17 is 1701-1703 Dogwood Circle, North Andover, MA 01845 (xiv) Building 18 is 1801-1806 Dogwood Circle, North Andover, MA 01845; (xv) Building 20 is 2001-2003 Dogwood Circle, North Andover, MA 01845; (xvi) Building 22 is 2201-2203 Juniper Circle, North Andover, MA 01845

<sup>2</sup> Closets, Mechanical Closets, Mechanical rooms, Bathrooms, Balconies and Decks are not included in the number of rooms in the column headed # of Rooms.

<sup>3</sup> The approximate area of the Unit in square feet set forth does not include any balcony or deck.

| Bldg # | Unit # | # of Rooms | Approx. Sq. Ft. | Location/ Floor(s)                                  | Proportionate Interest (%) for Units |
|--------|--------|------------|-----------------|---|--------------------------------------|
| 2      | 207    | 3          | 857             | Second  | 0.314952%                            |
| 2      | 208    | 4          | 1036            | Second  | 0.402187%                            |
| 2      | 209    | 3          | 813             | Second  | 0.314209%                            |
| 2      | 210    | 4          | 1261            | Second  | 0.402187%                            |
| 2      | 211    | 4          | 1032            | Second  | 0.341859%                            |
| 2      | 212    | 4          | 1117            | Second  | 0.402187%                            |
| 2      | 213    | 4          | 1118            | Second  | 0.402187%                            |
| 2      | 301    | 4          | 1121            | Third   | 0.402187%                            |
| 2      | 302    | 4          | 1118            | Third   | 0.402187%                            |
| 2      | 303    | 4          | 1043            | Third   | 0.341859%                            |
| 2      | 304    | 4          | 1267            | Third   | 0.402187%                            |
| 2      | 305    | 4          | 1257            | Third   | 0.402187%                            |
| 2      | 306    | 4          | 1031            | Third   | 0.341859%                            |
| 2      | 307    | 4          | 1257            | Third   | 0.402187%                            |
| 2      | 308    | 4          | 1038            | Third   | 0.402187%                            |
| 2      | 309    | 4          | 1035            | Third   | 0.402187%                            |
| 2      | 310    | 4          | 1264            | Third   | 0.402187%                            |
| 2      | 311    | 4          | 1117            | Third   | 0.341859%                            |
| 2      | 312    | 4          | 1121            | Third   | 0.402187%                            |
| 6      | 601    | 6          | 1912            | 1 <sup>st</sup> , 2 <sup>nd</sup> , 3 <sup>rd</sup> | 0.527870%                            |
| 6      | 602    | 5          | 1911            | 1 <sup>st</sup> , 2 <sup>nd</sup> , 3 <sup>rd</sup> | 0.527870%                            |
| 6      | 603    | 5          | 1904            | 1 <sup>st</sup> , 2 <sup>nd</sup> , 3 <sup>rd</sup> | 0.527870%                            |
| 6      | 604    | 6          | 1919            | 1 <sup>st</sup> , 2 <sup>nd</sup> , 3 <sup>rd</sup> | 0.527870%                            |
| 6      | 605    | 6          | 2044            | 1 <sup>st</sup> , 2 <sup>nd</sup> , 3 <sup>rd</sup> | 0.527870%                            |
| 6      | 606    | 6          | 1916            | 1 <sup>st</sup> , 2 <sup>nd</sup> , 3 <sup>rd</sup> | 0.527870%                            |
| 6      | 607    | 5          | 1909            | 1 <sup>st</sup> , 2 <sup>nd</sup> , 3 <sup>rd</sup> | 0.527870%                            |
| 6      | 608    | 5          | 1911            | 1 <sup>st</sup> , 2 <sup>nd</sup> , 3 <sup>rd</sup> | 0.373280%                            |
| 6      | 609    | 5          | 1905            | 1 <sup>st</sup> , 2 <sup>nd</sup> , 3 <sup>rd</sup> | 0.527870%                            |
| 6      | 610    | 5          | 1911            | 1 <sup>st</sup> , 2 <sup>nd</sup> , 3 <sup>rd</sup> | 0.373280%                            |
| 6      | 611    | 6          | 1908            | 1 <sup>st</sup> , 2 <sup>nd</sup> , 3 <sup>rd</sup> | 0.527870%                            |
| 6      | 612    | 7          | 1905            | 1 <sup>st</sup> , 2 <sup>nd</sup>                   | 0.527870%                            |
| 3      | 101    | 4          | 1149            | First   | 0.402187%                            |
| 3      | 102    | 4          | 1155            | First   | 0.402187%                            |
| 3      | 103    | 4          | 1054            | First   | 0.402187%                            |
| 3      | 104    | 3          | 859             | First   | 0.312952%                            |
| 3      | 105    | 3          | 850             | First   | 0.312952%                            |
| 3      | 106    | 4          | 1080            | First   | 0.402187%                            |
| 3      | 107    | 3          | 847             | First   | 0.314209%                            |
| 3      | 108    | 4          | 1079            | First   | 0.402187%                            |
| 3      | 109    | 3          | 854             | First   | 0.312952%                            |
| 3      | 110    | 3          | 858             | First   | 0.312952%                            |

| Bldg # | Unit # | # of Rooms | Approx. Sq. Ft. | Location/ Floor(s)                                  | Proportionate Interest (%) for Units |
|--------|--------|------------|-----------------|---|--------------------------------------|
| 3      | 111    | 4          | 1051            | First   | 0.402187%                            |
| 3      | 112    | 4          | 1150            | First   | 0.402187%                            |
| 3      | 113    | 4          | 1152            | First   | 0.402187%                            |
| 3      | 201    | 4          | 1116            | Second  | 0.402187%                            |
| 3      | 202    | 4          | 1114            | Second  | 0.402187%                            |
| 3      | 203    | 4          | 1029            | Second  | 0.341859%                            |
| 3      | 204    | 4          | 1264            | Second  | 0.402187%                            |
| 3      | 205    | 3          | 809             | Second  | 0.314209%                            |
| 3      | 206    | 4          | 1034            | Second  | 0.341859%                            |
| 3      | 207    | 3          | 848             | Second  | 0.312952%                            |
| 3      | 208    | 4          | 1035            | Second  | 0.402187%                            |
| 3      | 209    | 3          | 806             | Second  | 0.314209%                            |
| 3      | 210    | 4          | 1264            | Second  | 0.402187%                            |
| 3      | 211    | 4          | 1026            | Second  | 0.341859%                            |
| 3      | 212    | 4          | 1115            | Second  | 0.402187%                            |
| 3      | 213    | 4          | 1111            | Second  | 0.402187%                            |
| 3      | 301    | 4          | 1112            | Third   | 0.402187%                            |
| 3      | 302    | 4          | 1114            | Third   | 0.402187%                            |
| 3      | 303    | 4          | 1030            | Third   | 0.341859%                            |
| 3      | 304    | 4          | 1267            | Third   | 0.402187%                            |
| 3      | 305    | 4          | 1243            | Third   | 0.402187%                            |
| 3      | 306    | 4          | 1058            | Third   | 0.341859%                            |
| 3      | 307    | 4          | 1243            | Third   | 0.402187%                            |
| 3      | 308    | 4          | 1042            | Third   | 0.402187%                            |
| 3      | 309    | 4          | 1028            | Third   | 0.402187%                            |
| 3      | 310    | 4          | 1270            | Third   | 0.402187%                            |
| 3      | 311    | 4          | 1107            | Third   | 0.402187%                            |
| 3      | 312    | 4          | 1120            | Third   | 0.402187%                            |
| 9      | 901    | 6          | 1896            | 1 <sup>st</sup> , 2 <sup>nd</sup> , 3 <sup>rd</sup> | 0.527870%                            |
| 9      | 902    | 5          | 1918            | 1 <sup>st</sup> , 2 <sup>nd</sup> , 3 <sup>rd</sup> | 0.373280%                            |
| 9      | 903    | 6          | 1912            | 1 <sup>st</sup> , 2 <sup>nd</sup> , 3 <sup>rd</sup> | 0.527870%                            |
| 9      | 904    | 6          | 1912            | 1 <sup>st</sup> , 2 <sup>nd</sup> , 3 <sup>rd</sup> | 0.527870%                            |
| 9      | 905    | 5          | 1916            | 1 <sup>st</sup> , 2 <sup>nd</sup> , 3 <sup>rd</sup> | 0.373280%                            |
| 9      | 906    | 7          | 1905            | 1 <sup>st</sup> , 2 <sup>nd</sup> , 3 <sup>rd</sup> | 0.527870%                            |
| 11     | 1101   | 6          | 1636            | 1 <sup>st</sup> , 2 <sup>nd</sup>                   | 0.527870%                            |
| 11     | 1102   | 5          | 1917            | 1 <sup>st</sup> , 2 <sup>nd</sup> , 3 <sup>rd</sup> | 0.527870%                            |
| 11     | 1103   | 6          | 2106            | 1 <sup>st</sup> , 2 <sup>nd</sup> , 3 <sup>rd</sup> | 0.373280%                            |
| 11     | 1104   | 5          | 1715            | 1 <sup>st</sup> , 2 <sup>nd</sup> , 3 <sup>rd</sup> | 0.527870%                            |
| 11     | 1105   | 5          | 1911            | 1 <sup>st</sup> , 2 <sup>nd</sup> , 3 <sup>rd</sup> | 0.527870%                            |
| 11     | 1106   | 6          | 1646            | 1 <sup>st</sup> , 2 <sup>nd</sup>                   | 0.527870%                            |

| Bldg # | Unit # | # of Rooms | Approx. Sq. Ft. | Location/ Floor(s)                                  | Proportionate Interest (%) for Units |
|--------|--------|------------|-----------------|---|--------------------------------------|
| 13     | 1301   | 6          | 1909            | 1 <sup>st</sup> , 2 <sup>nd</sup> , 3 <sup>rd</sup> | 0.527870%                            |
| 13     | 1302   | 5          | 1915            | 1 <sup>st</sup> , 2 <sup>nd</sup> , 3 <sup>rd</sup> | 0.373280%                            |
| 13     | 1303   | 5          | 1917            | 1 <sup>st</sup> , 2 <sup>nd</sup> , 3 <sup>rd</sup> | 0.527870%                            |
| 13     | 1304   | 5          | 1720            | 1 <sup>st</sup> , 2 <sup>nd</sup> , 3 <sup>rd</sup> | 0.373280%                            |
| 13     | 1305   | 6          | 2110            | 1 <sup>st</sup> , 2 <sup>nd</sup> , 3 <sup>rd</sup> | 0.373280%                            |
| 13     | 1306   | 7          | 1936            | 1 <sup>st</sup> , 2 <sup>nd</sup>                   | 0.527870%                            |
| 14     | 1401   | 6          | 2099            | 1 <sup>st</sup> , 2 <sup>nd</sup> , 3 <sup>rd</sup> | 0.373280%                            |
| 14     | 1402   | 5          | 1712            | 1 <sup>st</sup> , 2 <sup>nd</sup> , 3 <sup>rd</sup> | 0.373280%                            |
| 14     | 1403   | 5          | 1907            | 1 <sup>st</sup> , 2 <sup>nd</sup> , 3 <sup>rd</sup> | 0.527870%                            |
| 14     | 1404   | 5          | 1910            | 1 <sup>st</sup> , 2 <sup>nd</sup> , 3 <sup>rd</sup> | 0.373280%                            |
| 14     | 1405   | 6          | 1897            | 1 <sup>st</sup> , 2 <sup>nd</sup> , 3 <sup>rd</sup> | 0.373280%                            |
| 15     | 1501   | 6          | 1896            | 1 <sup>st</sup> , 2 <sup>nd</sup> , 3 <sup>rd</sup> | 0.527870%                            |
| 15     | 1502   | 5          | 1909            | 1 <sup>st</sup> , 2 <sup>nd</sup> , 3 <sup>rd</sup> | 0.373280%                            |
| 15     | 1503   | 5          | 1566            | 1st, 2nd  | 0.527870%                            |
| 4E     | 101    | 4          | 1146            | First   | 0.402187%                            |
| 4E     | 102    | 4          | 1151            | First   | 0.402187%                            |
| 4E     | 103    | 4          | 1058            | First   | 0.341859%                            |
| 4E     | 104    | 4          | 1295            | First   | 0.402187%                            |
| 4E     | 105    | 4          | 1073            | First   | 0.402187%                            |
| 4E     | 106    | 4          | 1297            | First   | 0.341859%                            |
| 4E     | 107    | 4          | 1074            | First   | 0.402187%                            |
| 4E     | 108    | 3          | 856             | First   | 0.312952%                            |
| 4E     | 109    | 4          | 1296            | First   | 0.402187%                            |
| 4E     | 110    | 4          | 1293            | First   | 0.402187%                            |
| 4E     | 111    | 4          | 1292            | First   | 0.402187%                            |
| 4E     | 112    | 3          | 816             | First   | 0.312952%                            |
| 4N     | 113    | 4          | 1340            | First   | 0.402187%                            |
| 4N     | 114    | 4          | 1215            | First   | 0.402187%                            |
| 4N     | 115    | 4          | 1297            | First   | 0.341859%                            |
| 4N     | 116    | 4          | 1268            | First   | 0.341859%                            |
| 4N     | 117    | 4          | 1268            | First   | 0.402187%                            |
| 4N     | 118    | 3          | 860             | First   | 0.314209%                            |
| 4N     | 119    | 4          | 1080            | First   | 0.341859%                            |
| 4N     | 120    | 4          | 1294            | First   | 0.341859%                            |
| 4N     | 121    | 4          | 1073            | First   | 0.402187%                            |
| 4N     | 122    | 4          | 1297            | First   | 0.402187%                            |

| Bldg # | Unit # | # of Rooms | Approx. Sq. Ft. | Location/ Floor(s) | Proportionate Interest (%) for Units |
|--------|--------|------------|-----------------|--------------------|--------------------------------------|
| 4N     | 123    | 4          | 1057            | First              | 0.341859%                            |
| 4N     | 124    | 4          | 1149            | First              | 0.402187%                            |
| 4N     | 125    | 4          | 1149            | First              | 0.402187%                            |
| 4E     | 201    | 4          | 1108            | Second             | 0.402187%                            |
| 4E     | 202    | 4          | 1113            | Second             | 0.402187%                            |
| 4E     | 203    | 4          | 1020            | Second             | 0.402187%                            |
| 4E     | 204    | 4          | 1253            | Second             | 0.402187%                            |
| 4E     | 205    | 4          | 1035            | Second             | 0.341859%                            |
| 4E     | 206    | 4          | 1255            | Second             | 0.341859%                            |
| 4E     | 207    | 4          | 1035            | Second             | 0.402187%                            |
| 4E     | 208    | 4          | 1271            | Second             | 0.402187%                            |
| 4E     | 209    | 4          | 1255            | Second             | 0.341859%                            |
| 4E     | 210    | 4          | 1256            | Second             | 0.402187%                            |
| 4E     | 211    | 4          | 1255            | Second             | 0.402187%                            |
| 4E     | 212    | 3          | 738             | Second             | 0.312952%                            |
| 4N     | 213    | 4          | 1304            | Second             | 0.402187%                            |
| 4N     | 214    | 2          | 1369            | Second             | 0.314209%                            |
| 4N     | 215    | 4          | 1179            | Second             | 0.402187%                            |
| 4N     | 216    | 4          | 1261            | Second             | 0.341859%                            |
| 4N     | 217    | 4          | 1230            | Second             | 0.402187%                            |
| 4N     | 218    | 4          | 1227            | Second             | 0.341859%                            |
| 4N     | 219    | 4          | 1033            | Second             | 0.341859%                            |
| 4N     | 220    | 4          | 1269            | Second             | 0.402187%                            |
| 4N     | 221    | 4          | 1033            | Second             | 0.402187%                            |
| 4N     | 222    | 4          | 1255            | Second             | 0.341859%                            |
| 4N     | 223    | 4          | 1036            | Second             | 0.402187%                            |
| 4N     | 224    | 4          | 1255            | Second             | 0.402187%                            |
| 4N     | 225    | 4          | 1112            | Second             | 0.402187%                            |
| 4N     | 226    | 4          | 1111            | Second             | 0.402187%                            |
| 4E     | 301    | 4          | 1110            | Third              | 0.402187%                            |
| 4E     | 302    | 4          | 1110            | Third              | 0.402187%                            |
| 4E     | 303    | 4          | 1020            | Third              | 0.341859%                            |
| 4E     | 304    | 4          | 1259            | Third              | 0.402187%                            |
| 4E     | 305    | 4          | 1035            | Third              | 0.402187%                            |
| 4E     | 306    | 4          | 1259            | Third              | 0.402187%                            |
| 4E     | 307    | 4          | 1043            | Third              | 0.341859%                            |
| 4E     | 308    | 4          | 1271            | Third              | 0.402187%                            |
| 4E     | 309    | 4          | 1255            | Third              | 0.402187%                            |
| 4E     | 310    | 4          | 1256            | Third              | 0.341859%                            |
| 4E     | 311    | 4          | 1254            | Third              | 0.402187%                            |
| 4E     | 312    | 3          | 741             | Third              | 0.314209%                            |

| Bldg # | Unit # | # of Rooms | Approx. Sq. Ft. | Location/ Floor(s) | Proportionate Interest (%) for Units |
|--------|--------|------------|-----------------|--------------------|--------------------------------------|
| 4N     | 313    | 4          | 1304            | Third              | 0.402187%                            |
| 4N     | 314    | 2          | 1369            | Third              | 0.314209%                            |
| 4N     | 315    | 4          | 1179            | Third              | 0.402187%                            |
| 4N     | 316    | 4          | 1264            | Third              | 0.341859%                            |
| 4N     | 317    | 4          | 1230            | Third              | 0.402187%                            |
| 4N     | 318    | 4          | 1225            | Third              | 0.402187%                            |
| 4N     | 319    | 4          | 1034            | Third              | 0.341859%                            |
| 4N     | 320    | 4          | 1269            | Third              | 0.402187%                            |
| 4N     | 321    | 4          | 1034            | Third              | 0.402187%                            |
| 4N     | 322    | 4          | 1260            | Third              | 0.402187%                            |
| 4N     | 323    | 4          | 1037            | Third              | 0.341859%                            |
| 4N     | 324    | 4          | 1258            | Third              | 0.402187%                            |
| 4N     | 325    | 4          | 1112            | Third              | 0.402187%                            |
| 4N     | 326    | 4          | 1112            | Third              | 0.402187%                            |
| 1      | 101    | 4          | 1154            | First              | 0.341859%                            |
| 1      | 102    | 4          | 1156            | First              | 0.402187%                            |
| 1      | 103    | 3          | 855             | First              | 0.314209%                            |
| 1      | 104    | 3          | 852             | First              | 0.312952%                            |
| 1      | 105    | 3          | 852             | First              | 0.312952%                            |
| 1      | 106    | 4          | 1074            | First              | 0.402187%                            |
| 1      | 107    | 3          | 849             | First              | 0.314209%                            |
| 1      | 108    | 4          | 1079            | First              | 0.402187%                            |
| 1      | 109    | 3          | 851             | First              | 0.312952%                            |
| 1      | 110    | 3          | 852             | First              | 0.312952%                            |
| 1      | 111    | 3          | 857             | First              | 0.314209%                            |
| 1      | 112    | 4          | 1155            | First              | 0.402187%                            |
| 1      | 113    | 4          | 1154            | First              | 0.402187%                            |
| 1      | 201    | 4          | 1115            | Second             | 0.402187%                            |
| 1      | 202    | 4          | 1115            | Second             | 0.402187%                            |
| 1      | 203    | 4          | 1035            | Second             | 0.341859%                            |
| 1      | 204    | 4          | 1271            | Second             | 0.402187%                            |
| 1      | 205    | 3          | 812             | Second             | 0.314209%                            |
| 1      | 206    | 4          | 1035            | Second             | 0.402187%                            |
| 1      | 207    | 3          | 850             | Second             | 0.312952%                            |
| 1      | 208    | 4          | 1034            | Second             | 0.402187%                            |
| 1      | 209    | 3          | 813             | Second             | 0.314209%                            |
| 1      | 210    | 4          | 1261            | Second             | 0.402187%                            |
| 1      | 211    | 4          | 1032            | Second             | 0.341859%                            |
| 1      | 212    | 4          | 1121            | Second             | 0.402187%                            |
| 1      | 213    | 4          | 1118            | Second             | 0.402187%                            |
| 1      | 301    | 4          | 1120            | Third              | 0.402187%                            |
| 1      | 302    | 4          | 1118            | Third              | 0.402187%                            |

| Bldg # | Unit # | # of Rooms | Approx. Sq. Ft. | Location/Floor(s)                                   | Proportionate Interest (%) for Units |
|--------|--------|------------|-----------------|---|--------------------------------------|
| 1      | 303    | 4          | 1037            | Third   | 0.341859%                            |
| 1      | 304    | 4          | 1263            | Third   | 0.402187%                            |
| 1      | 305    | 4          | 1250            | Third   | 0.402187%                            |
| 1      | 306    | 4          | 1034            | Third   | 0.402187%                            |
| 1      | 307    | 4          | 1253            | Third   | 0.341859%                            |
| 1      | 308    | 4          | 1038            | Third   | 0.402187%                            |
| 1      | 309    | 4          | 1033            | Third   | 0.402187%                            |
| 1      | 310    | 4          | 1264            | Third   | 0.402187%                            |
| 1      | 311    | 4          | 1117            | Third   | 0.341859%                            |
| 1      | 312    | 4          | 1121            | Third   | 0.402187%                            |
| 16     | 1601   | 4          | 1998            | 1 <sup>st</sup> , 2 <sup>nd</sup>                   | 0.527870%                            |
| 16     | 1602   | 5          | 2109            | 1 <sup>st</sup> , 2 <sup>nd</sup> , 3 <sup>rd</sup> | 0.527870%                            |
| 16     | 1603   | 5          | 2366            | 1 <sup>st</sup> , 2 <sup>nd</sup> , 3 <sup>rd</sup> | 0.527870%                            |
| 16     | 1604   | 5          | 2111            | 1 <sup>st</sup> , 2 <sup>nd</sup> , 3 <sup>rd</sup> | 0.373280%                            |
| 16     | 1605   | 5          | 2114            | 1 <sup>st</sup> , 2 <sup>nd</sup> , 3 <sup>rd</sup> | 0.527870%                            |
| 16     | 1606   | 6          | 2180            | 1 <sup>st</sup> , 2 <sup>nd</sup>                   | 0.527870%                            |
| 17     | 1701   | 7          | 2764            | 1 <sup>st</sup> , 2 <sup>nd</sup> , 3 <sup>rd</sup> | 0.527870%                            |
| 17     | 1702   | 6          | 2264            | 1 <sup>st</sup> , 2 <sup>nd</sup> , 3 <sup>rd</sup> | 0.373280%                            |
| 17     | 1703   | 6          | 2283            | 1 <sup>st</sup> , 2 <sup>nd</sup> , 3 <sup>rd</sup> | 0.527870%                            |
| 18     | 1801   | 7          | 3026            | 1 <sup>st</sup> , 2 <sup>nd</sup> , 3 <sup>rd</sup> | 0.527870%                            |
| 18     | 1802   | 5          | 2083            | 1 <sup>st</sup> , 2 <sup>nd</sup> , 3 <sup>rd</sup> | 0.527870%                            |
| 18     | 1803   | 5          | 1906            | 1 <sup>st</sup> , 2 <sup>nd</sup> , 3 <sup>rd</sup> | 0.527870%                            |
| 18     | 1804   | 5          | 2273            | 1 <sup>st</sup> , 2 <sup>nd</sup> , 3 <sup>rd</sup> | 0.527870%                            |
| 18     | 1805   | 5          | 2083            | 1 <sup>st</sup> , 2 <sup>nd</sup> , 3 <sup>rd</sup> | 0.527870%                            |
| 18     | 1806   | 7          | 3030            | 1 <sup>st</sup> , 2 <sup>nd</sup> , 3 <sup>rd</sup> | 0.527870%                            |
| 20     | 2001   | 8          | 2160            | 1 <sup>st</sup> , 2 <sup>nd</sup> , 3 <sup>rd</sup> | 0.527870%                            |
| 20     | 2002   | 8          | 2118            | 1 <sup>st</sup> , 2 <sup>nd</sup>                   | 0.373280%                            |
| 20     | 2003   | 7          | 3028            | 1 <sup>st</sup> , 2 <sup>nd</sup> , 3 <sup>rd</sup> | 0.527870%                            |
| 22     | 2201   | 7          | 3022            | 1 <sup>st</sup> , 2 <sup>nd</sup> , 3 <sup>rd</sup> | 0.527870%                            |
| 22     | 2202   | 5          | 2290            | 1 <sup>st</sup> , 2 <sup>nd</sup> , 3 <sup>rd</sup> | 0.373280%                            |
| 22     | 2203   | 5          | 2341            | 1 <sup>st</sup> , 2 <sup>nd</sup> , 3 <sup>rd</sup> | 0.527870%                            |
|        |        |            |                 |   | <b>100.000000%</b>                   |

Immediate common areas to which each Unit has access are the common hallways or Building exterior, as shown on the Floor Plans.